

Re-survey
Township N. 26. A. Range N. 7 W. Mer. Mich.

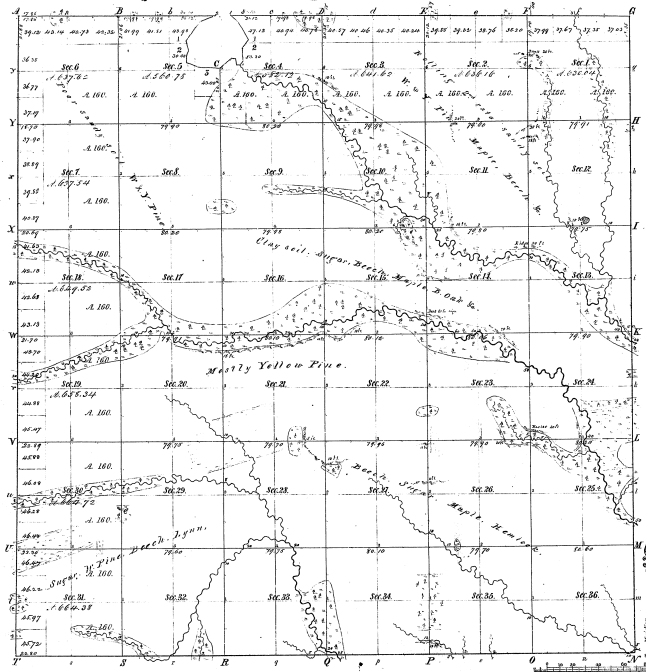

Monitors of
 Public Courses 18-22 Public Courses 23-27 Public Courses 28-32

22-19
 22-19

Total number of Acres. **22962.84**

| Survey designated | By Whom Surveyed | Date of Contract | Amount of Survey | When Surveyed | Plan of the land and also of the Survey "as laid out" |
|-------------------|------------------|------------------|------------------|---------------|---|
| Township lines | James Buchanan | July 26, 1857 | 36 - 360 - 150 | 1857 | 2153 |
| Subdivisions | John M. Mallard | July 24, 1866 | 81.32 - 52 | 1866 | 1226 |

The above Map of Township N. 26. North, of Range N. 7 West of the Principal Meridian - Michigan is strictly conformable to the field notes of the survey thereon on file in this Office which have been examined and approved.
 Surveyor General's Office.
 Detroit, Mich. 4th Nov. 1866
 Lewis Lyon
 Sur. Gen.

TOWNSHIP 26 NORTH, RANGE 7 EAST, MICHIGAN MERIDIAN,
SURVEY OF ISLAND IN SECTIONS 4 AND 5

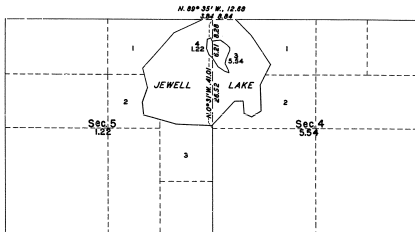
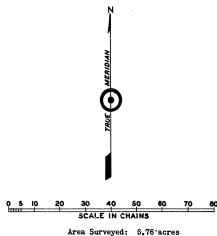

22-19

Field Notes of Survey

Surveys as represented hereon were executed with a Corley solar transit, constructed in accordance with Bureau of Land Management specifications, which transit was in good condition and was placed in satisfactory adjustment prior to undertaking this work. Directions of all lines refer to the true meridian and were determined by the solar transit method or by prolongation of celestial observations. Distances are expressed in chains, measured on the slope, reduced to horizontal equivalents.

The point for M.C. of secs. 4 and 33, T₂₆ N. and R₇ E., on E. shore of Jewell Lake is skid. by a concrete monument, 4 ins. sq. projecting 6 ins. above ground, with iron rod in center; the point was not recommended.

N. 89° 35' W., on line between secs. 4 and 33, over Jewell Lake; distance obtained by triangulation.

8.84 Proportions point for cor. of secs. 4, 5, 32 and 33, in lake; continue with same course and distance, along line bet. secs. 5 and 32.

12.00 An iron pipe, 2½ ins. diam., projecting 26 ins. above ground, in marsh; this point and for alignment only. The lake has receded several feet in the past 20 yrs. and this pipe has been established to fit the new shore line.

12.68 Point for H.C. of secs. 5 and 32 at record distance on N. shore of lake falls at proper position on old encroachment; I did not monument this point.

The point for ½ sec. cor. of secs. 4 and 5, skid. by a rotted survey pine stump half, 36 ins. diam., with an iron T-plate and wood stake driven in center, the apparent original corner tree.

At the corner point

Set a regulation iron post, 2½ ins. diam., with brass cap skid.

S 51° 24'
126 N 1/2 E
1858

from which

A maple, 4 ins. diam., brs. S. 70° E., 22 lks., skid. 2 54 Ft.
A maple, 5 ins. diam., brs. S. 48½° W., 77 lks., skid. 2 56 Ft.

Thence, N. 0° 31' W., bet. secs. 4 and 5, crossing Jewell Lake; distance obtained by triangulation.

0.85 Point on S. shore of lake, now lowered.

26.52 S. shore of island and point for M.C.

Set a regulation iron post, 2½ ins. diam., with brass cap skid.

T 26 N 1/2 E
S 51° 24'
1858

from which

M.C.
1958
A maple, 10 ins., N. 47½° E., 35 lks., skid. T20N R7E S4 NE FT.
A survey pine, 7 ins., N. 41° W., 28 lks., skid. T20N R7E S5 NE FT.
Thence crossing island; continue same course and distance.

29.00 Abandoned house, on line.

31.80 Enter swamp, brs. E. and W.

32.73 N. shore of island and point for M.C.

Set a regulation iron post, 2½ ins. diam., with brass cap skid.

M.C.
S 51° 24'
T 26 N 1/2 E
1858

from which

S 51° 24', bears S. 37½° E., 23 lks., skid. T20N R7E S4 NE FT.
Cedar, 6 ins., bears S. 55½° W., 12 lks., skid. T20N R7E S5 NE FT.
Thence over Jewell Lake

41.01 Point for cor. of secs. 4, 5, 32 and 33, on N. bdy. of T₂₆ N., in lake.

Boundaries of Island

From M.C. of sec. 4 and 5, on S. shore of island; thence with meanders, along a well-defined shore, timber on bank above beach.

| | |
|--------------------------|--------------------------|
| S. 23° 00' E., 4.28 chs. | N. 29° 00' E., 3.80 chs. |
| S. 37° 30' E., 3.20 chs. | N. 3° 45' E., 1.00 chs. |
| S. 71° 00' E., 1.50 chs. | N. 42° 30' W., 1.20 chs. |
| N. 13° 00' W., 1.20 chs. | N. 54° 00' W., 2.20 chs. |
| N. 28° 00' W., 2.50 chs. | S. 80° 20' W., 3.03 chs. |
| N. 6° 45' E., 1.00 chs. | |

Thence in sec. 5.

| | |
|--------------------------|---|
| N. 24° 00' W., 1.36 chs. | S. 21° 30' E., 2.50 chs. |
| S. 60° 15' W., 1.20 chs. | S. 48° 15' E., 1.77 chs. |
| S. 4° 00' W., 3.40 chs. | to M.C. on S. shore and place of beginning. |

General Description

The island is of sandy loam formation with some silt in the swamp area. It reaches approx. 15 ft. above the level of Jewell Lake. The timber species consists of Norway pine, maple, birch, cedar, oak and elm, ranging in size from 4 to 20 ins. diam.; the older timber has been cut for many years and stumps are found to 30 ins. diam. There is an abandoned 3 room house on the island, which is rapidly deteriorating, built and occupied for many years by Andrew Freer. The formation of the island is similar to that of the mainland included in the original surveyed areas, and the timber growth thereon attests to the fact that it was in existence in 1837, when Michigan was admitted into the Union, and has been in continuous existence since that date, therefore has the status of public land. The island is well over 506 upland in character; there is a strip of swamp along the E. and W. sides of the island.

UNITED STATES DEPARTMENT OF THE INTERIOR
BUREAU OF LAND MANAGEMENT
Washington, D.C. August 4, 1959

This plat is strictly conformable to the above field notes of survey, which have been critically examined and found correct, and are hereby approved, and the survey, having been properly executed in accordance with the requirements of law and the regulations of this Bureau, is hereby accepted.

For the Director
Earl G. Starvo
District Engineer, Staff Officer

I HEREBY CERTIFY UPON HONOR that, in pursuance of Special Instructions for Group IV, Michigan, bearing date of August 5, 1958, and Assignment Instructions dated August 5, 1958, I executed survey from 18 to 18 September, 1959, the island in Jewell Lake, sec. 4 and 5, T₂₆ N., R₇ E., Michigan Meridian, in the State of Michigan, which is represented by this diagram and field notes of survey, and that said survey has been made in strict conformity with said instructions, the Manual of Instructions for Survey of the Public Lands of the United States, and in the specific manner described in the notes of survey.

Hugh B. Crawford
Hugh B. Crawford
Cadastral Surveyor

June 19, 1959.

This plat represents the complete record of survey.