

Township N. VIII South, Range N. XII West Abq. (Mts. Ter.)

L. S. L. E. M I C H I G A N.

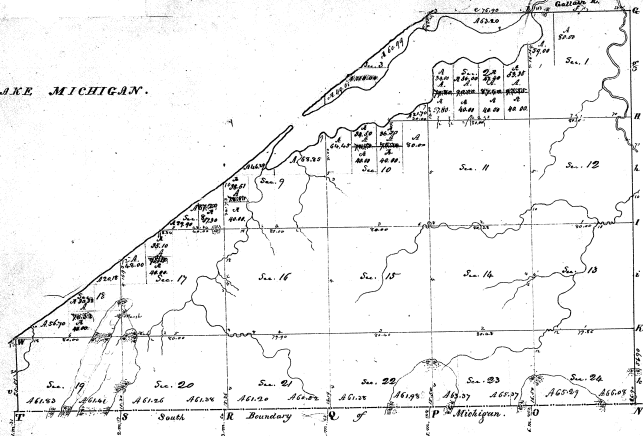

37

Sections		
Section	Area	Acres
1 NE	1	160
2 E. 1/2 SW	-	80
3 NW	-	160
4 SW	-	160
5 N. 1/2 SE	2	80
6 E. 1/2 SE	-	80
7 NW	-	160
8 E. 1/2 SW	-	80
9 NW	-	160
10 NW	-	160
11 NW	-	160
12 NW	-	160
13 NW	-	160
14 NW	-	160
15 NW	-	160
16 NW	-	160
17 NW	-	160
18 NW	-	160
19 NW	-	160
20 NW	-	160
21 NW	-	160
22 NW	-	160
23 NW	-	160
24 NW	-	160
25 NW	-	160
26 NW	-	160
27 NW	-	160
28 NW	-	160
29 NW	-	160
30 NW	-	160
31 NW	-	160
32 NW	-	160
33 NW	-	160
34 NW	-	160
35 NW	-	160
36 NW	-	160
Total		5760

1-37

Surveyed in October 1889 by James W. ...

Scale 1" = 400' or 1/4" = 100'