

33-15
33-15

LOT N^o 4
ON ISLAND N^o 16
AND LOTS N^o 1, 2 & 3 ON ISO. N^o 20 - IN SEC. 31
TOWNSHIP N^o 43 NORTH, RANGE N^o 5 EAST
PRINCIPAL MERIDIAN MICHIGAN
SCALE 20 CHAINS TO AN INCH

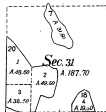

6203

JK

DEPARTMENT OF THE INTERIOR
GENERAL LAND OFFICE

Washington, D.C. September 16th 1898

I hereby certify that the above is a part of a plat of the subdivisions made in accordance with Section 2205 U.S. Revised Statute of Section 31 Township N^o 43 North, Range N^o 5 East Principal Mer. Michigan.

J. M. Smith
Acting Commissioner
and in office Surveyor General of Michigan.

TOWNSHIP 43 NORTH, RANGE 5 EAST, OF THE MICHIGAN MERIDIAN, MICHIGAN.
SURVEY OF ISLANDS

43-15



POTAGAMISSING

DAY
MEANS, 1897, 830' 00"
Island No. 18

DAY

8325.15 ± 0.06

Length: 45°56'2" W
Length: 83°50'7" W



A history of surveys is contained in the field notes.

This plat, in two sheets, represents the survey of five islands in Potagamissing Bay, T. 43 N., R. 5 E., Michigan Territory, Michigan.

Except as indicated herein, the settings and areas are as shown on the plats approved January 31, 1846, and September 15, 1898.

Survey executed by GUY L. STRAS, Coastal Surveyor, beginning October 18, 1937, and completed October 19, 1937, pursuant to Special Instructions dated June 3, 1937, for Group No. 78, Michigan.

UNITED STATES DEPARTMENT OF THE INTERIOR
BUREAU OF LAND MANAGEMENT
Denver, Colorado December 15, 1981

This plat is strictly conformable to the approved field notes, and the survey, having been correctly executed in accordance with the requirements of law and the regulations of this Bureau, is hereby accepted.

For the Director

James S. Gilbert

Acting Chief, Coastal Survey
Examination and Approval Staff

TOWNSHIP 43 NORTH, RANGE 5 EAST, OF THE MICHIGAN MERIDIAN, MICHIGAN.

SURVEY OF ISLANDS

33-15

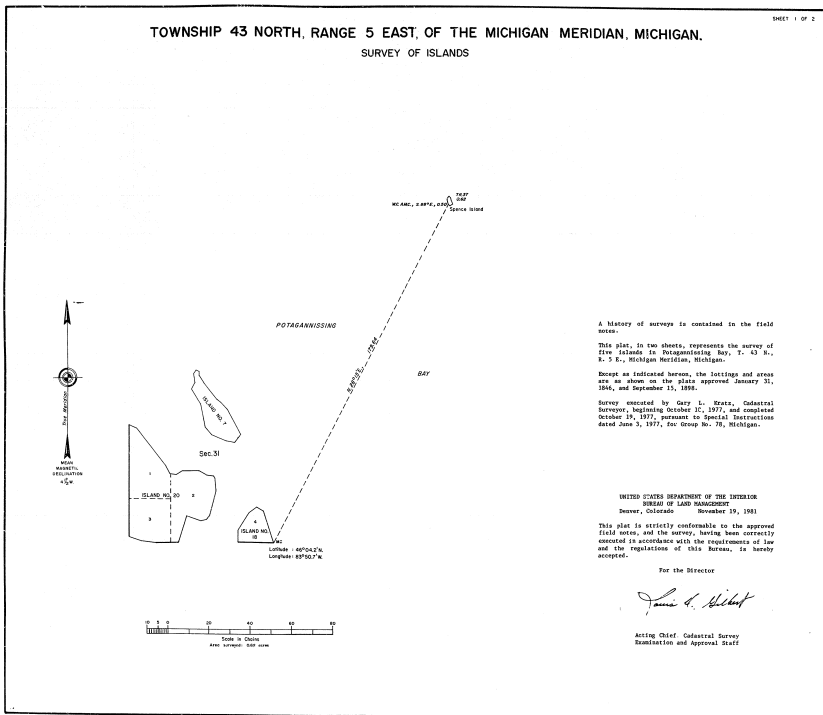

24

16

16

12 12

16

16

