

Township N. VI north, Range N. II west (cont. Sec.)

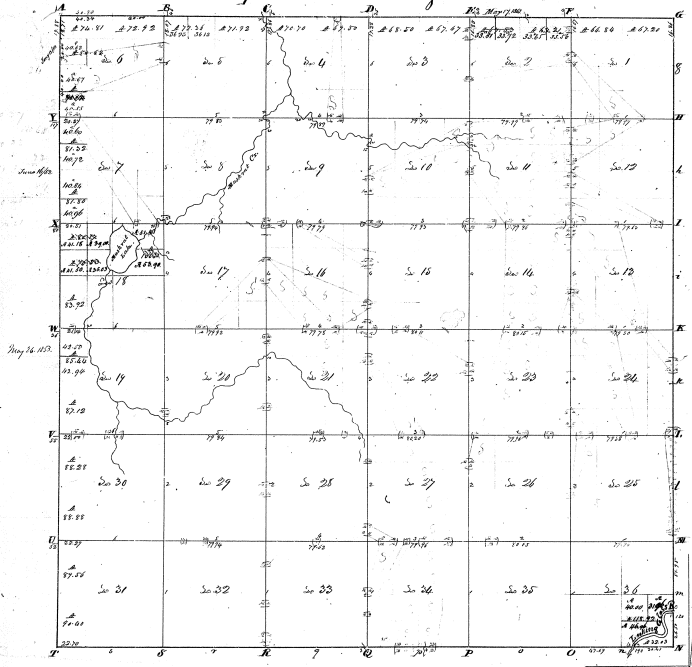

Surveyed in June 1864 by Henry Parks

Surveyor General's office June 26th 1877
Wm. C. Coffey

519

Sec 1	67	20	60	30	1.61
Sec 2	60	10	30	30	1.61
Sec 3	80		30	30	1.61
Sec 4	320		30	30	1.61
Sec 5	80	21	25	30	1.61
Sec 6	80		21	30	1.61
Sec 7	47	50	30	30	1.61
Sec 8	320		30	30	1.61
Sec 9	67	67	80	30	2.20
Sec 10	80		80	80	2.20
Sec 11	80	50	80	80	2.20
Sec 12	80		80	80	2.20
Sec 13	320		80	80	2.20
Sec 14	67	50	80	80	2.20
Sec 15	80	71	80	80	2.20
Sec 16	80		80	80	2.20
Sec 17	320		80	80	2.20
Sec 18	71	72	80	80	2.20
Sec 19	80	31	80	80	2.20
Sec 20	80		80	80	2.20
Sec 21	320		80	80	2.20
Sec 22	72	72	80	80	2.20
Sec 23	80		80	80	2.20
Sec 24	80		80	80	2.20
Sec 25	80		80	80	2.20
Sec 26	80		80	80	2.20
Sec 27	80		80	80	2.20
Sec 28	80		80	80	2.20
Sec 29	80		80	80	2.20
Sec 30	80		80	80	2.20
Sec 31	80		80	80	2.20
Sec 32	80		80	80	2.20
Sec 33	80		80	80	2.20
Sec 34	80		80	80	2.20
Sec 35	80		80	80	2.20
Sec 36	80		80	80	2.20
Sec 37	80		80	80	2.20
Sec 38	80		80	80	2.20
Sec 39	80		80	80	2.20
Sec 40	80		80	80	2.20
Sec 41	80		80	80	2.20
Sec 42	80		80	80	2.20
Sec 43	80		80	80	2.20
Sec 44	80		80	80	2.20
Sec 45	80		80	80	2.20
Sec 46	80		80	80	2.20
Sec 47	80		80	80	2.20
Sec 48	80		80	80	2.20
Sec 49	80		80	80	2.20
Sec 50	80		80	80	2.20
Sec 51	80		80	80	2.20
Sec 52	80		80	80	2.20
Sec 53	80		80	80	2.20
Sec 54	80		80	80	2.20
Sec 55	80		80	80	2.20
Sec 56	80		80	80	2.20
Sec 57	80		80	80	2.20
Sec 58	80		80	80	2.20
Sec 59	80		80	80	2.20
Sec 60	80		80	80	2.20
Sec 61	80		80	80	2.20
Sec 62	80		80	80	2.20
Sec 63	80		80	80	2.20
Sec 64	80		80	80	2.20
Sec 65	80		80	80	2.20
Sec 66	80		80	80	2.20
Sec 67	80		80	80	2.20
Sec 68	80		80	80	2.20
Sec 69	80		80	80	2.20
Sec 70	80		80	80	2.20
Sec 71	80		80	80	2.20
Sec 72	80		80	80	2.20
Sec 73	80		80	80	2.20
Sec 74	80		80	80	2.20
Sec 75	80		80	80	2.20
Sec 76	80		80	80	2.20
Sec 77	80		80	80	2.20
Sec 78	80		80	80	2.20
Sec 79	80		80	80	2.20
Sec 80	80		80	80	2.20
Sec 81	80		80	80	2.20
Sec 82	80		80	80	2.20
Sec 83	80		80	80	2.20
Sec 84	80		80	80	2.20
Sec 85	80		80	80	2.20
Sec 86	80		80	80	2.20
Sec 87	80		80	80	2.20
Sec 88	80		80	80	2.20
Sec 89	80		80	80	2.20
Sec 90	80		80	80	2.20
Sec 91	80		80	80	2.20
Sec 92	80		80	80	2.20
Sec 93	80		80	80	2.20
Sec 94	80		80	80	2.20
Sec 95	80		80	80	2.20
Sec 96	80		80	80	2.20
Sec 97	80		80	80	2.20
Sec 98	80		80	80	2.20
Sec 99	80		80	80	2.20
Sec 100	80		80	80	2.20
Sec 101	80		80	80	2.20
Sec 102	80		80	80	2.20
Sec 103	80		80	80	2.20
Sec 104	80		80	80	2.20
Sec 105	80		80	80	2.20
Sec 106	80		80	80	2.20
Sec 107	80		80	80	2.20
Sec 108	80		80	80	2.20
Sec 109	80		80	80	2.20
Sec 110	80		80	80	2.20
Sec 111	80		80	80	2.20
Sec 112	80		80	80	2.20
Sec 113	80		80	80	2.20
Sec 114	80		80	80	2.20
Sec 115	80		80	80	2.20
Sec 116	80		80	80	2.20
Sec 117	80		80	80	2.20
Sec 118	80		80	80	2.20
Sec 119	80		80	80	2.20
Sec 120	80		80	80	2.20
Sec 121	80		80	80	2.20
Sec 122	80		80	80	2.20
Sec 123	80		80	80	2.20
Sec 124	80		80	80	2.20
Sec 125	80		80	80	2.20
Sec 126	80		80	80	2.20
Sec 127	80		80	80	2.20
Sec 128	80		80	80	2.20
Sec 129	80		80	80	2.20
Sec 130	80		80	80	2.20
Sec 131	80		80	80	2.20
Sec 132	80		80	80	2.20
Sec 133	80		80	80	2.20
Sec 134	80		80	80	2.20
Sec 135	80		80	80	2.20
Sec 136	80		80	80	2.20
Sec 137	80		80	80	2.20
Sec 138	80		80	80	2.20
Sec 139	80		80	80	2.20
Sec 140	80		80	80	2.20
Sec 141	80		80	80	2.20
Sec 142	80		80	80	2.20
Sec 143	80		80	80	2.20
Sec 144	80		80	80	2.20
Sec 145	80		80	80	2.20
Sec 146	80		80	80	2.20
Sec 147	80		80	80	2.20
Sec 148	80		80	80	2.20
Sec 149	80		80	80	2.20
Sec 150	80		80	80	2.20
Sec 151	80		80	80	2.20
Sec 152	80		80	80	2.20
Sec 153	80		80	80	2.20
Sec 154	80		80	80	2.20
Sec 155	80		80	80	2.20
Sec 156	80		80	80	2.20
Sec 157	80		80	80	2.20
Sec 158	80		80	80	2.20
Sec 159	80		80	80	2.20
Sec 160	80		80	80	2.20
Sec 161	80		80	80	2.20
Sec 162	80		80	80	2.20
Sec 163	80		80	80	2.20
Sec 164	80		80	80	2.20
Sec 165	80		80	80	2.20
Sec 166	80		80	80	2.20
Sec 167	80		80	80	2.20
Sec 168	80		80	80	2.20
Sec 169	80		80	80	2.20
Sec 170	80		80	80	2.20
Sec 171	80		80	80	2.20
Sec 172	80		80	80	2.20
Sec 173	80		80	80	2.20
Sec 174	80		80	80	2.20
Sec 175	80		80	80	2.20
Sec 176	80		80	80	2.20
Sec 177	80		80	80	2.20
Sec 178	80		80	80	2.20
Sec 179	80		80	80	2.20
Sec 180	80		80	80	2.20
Sec 181	80		80	80	2.20
Sec 182	80		80	80	2.20
Sec 183	80		80	80	2.20
Sec 184	80		80	80	2.20
Sec 185	80		80	80	2.20
Sec 186	80		80	80	2.20
Sec 187	80		80	80	2.20
Sec 188	80		80	80	2.20
Sec 189	80		80	80	2.20
Sec 190	80		80	80	2.20
Sec 191	80		80	80	2.20
Sec 192	80		80	80	2.20
Sec 193	80		80	80	2.20
Sec 194	80		80	80	2.20
Sec 195	80		80	80	2.20
Sec 196	80		80	80	2.20
Sec 197	80		80	80	2.20
Sec 198	80		80	80	2.20
Sec 199	80		80	80	2.20
Sec 200	80		80	80	2.20
Sec 201	80		80	80	2.20
Sec 202	80		80	80	2.20
Sec 203	80		80	80	2.20
Sec 204	80		80	80	2.20
Sec 205	80		80	80	2.20
Sec 206	80		80	80	2.20
Sec 207	80		80	80	2.20
Sec 208	80		80	80	2.20
Sec 209	80		80	80	2.20
Sec 210	80		80	80	2.20
Sec 211	80		80	80	2.20
Sec 212	80		80	80	2.20
Sec 213					