

Re-survey  
 Township 1° 27' N. Range 1° 4' W. Mer. Mich.

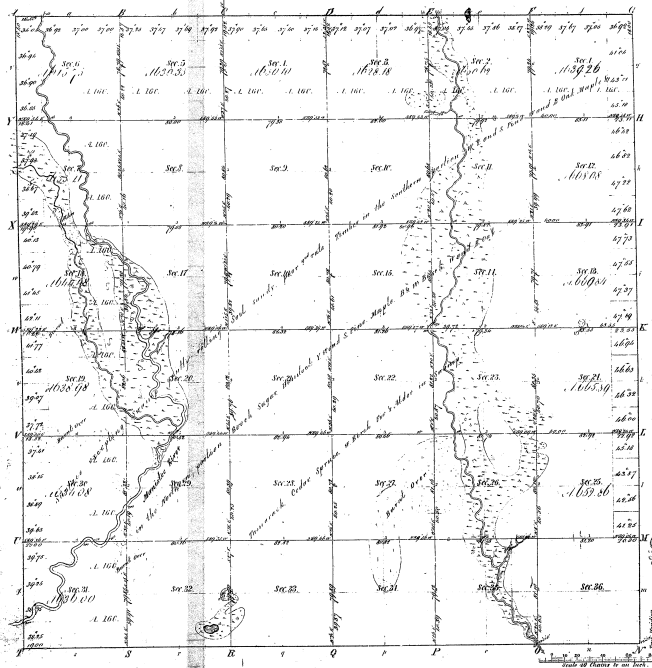

Meridian of  
 Public Course 1842 Public Course 1844 Public Course 1846

14-16

1A-16

Total number of Acres, 23,657.66

Survey designated	By Whom Surveyed	Date of Landbook	Amount of Survey	When Surveyed	When the Mer. Mich. Survey was made
Township, Range	James H. McMillan	Mar. 10, 1859	23,657.66	1859	1859
Subdivisions	John W. Brown	Jan. 1, 1858	60,000.00	1858	1858

The above Map of Township 1° 27' North of Range 1° 4' West of the Principal Meridian Meridian is a truly correct and a full notice of the survey being made in this office, which has been examined and approved.

Surveyor General's Office  
 Detroit Dec. 29 1858  
 Charles H. P. Usher  
 Surveyor General