

Township 1° 42' N Range 1° 23' W Mer. Mich.

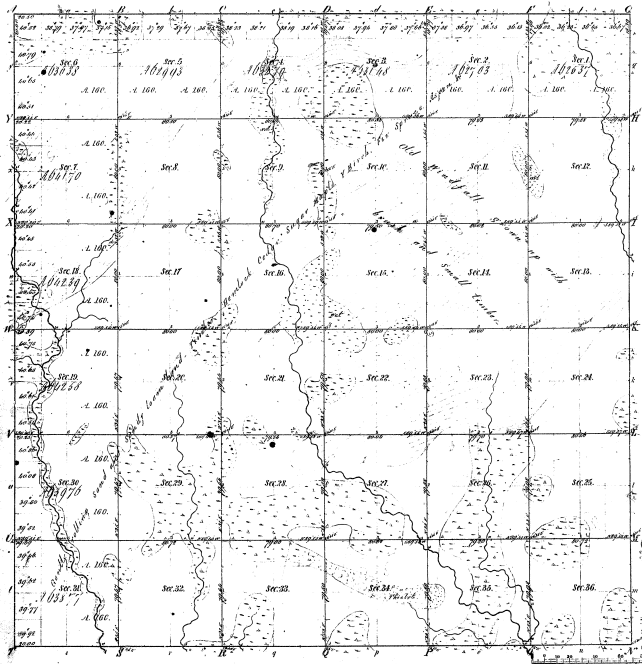

Boundaries of
 Pre-1836 Courses 1836-1864
 Pre-1836 Courses 1864-1924
 Pre-1836 Courses 1924-1964

38-33

38-33

Total number of Acres 27,088.11

Average Depth	By Whom Surveyed	Date of Contract	Number of Acres	Area Surveyed	Area of Cont'd
Township 1° 42' N	John A. Ward	May 26 1864	27,088.11	27,088.11	27,088.11
Subdivisions	John A. Ward	June 15 1864	27,088.11	27,088.11	27,088.11
Subdivisions	A. McLeod	September 18 76	27,088.11	27,088.11	27,088.11

The above map of Township 1° 42' North of Range 1° 23' West of the Principal Meridian Michigan is a study conformable to the field notes of the survey thereon filed in this office and approved
 Surveyor General's Office
 Charles Chapman
 Detroit April 24 1873