

Township 43 N. Range 29 W. Mer. Mich.

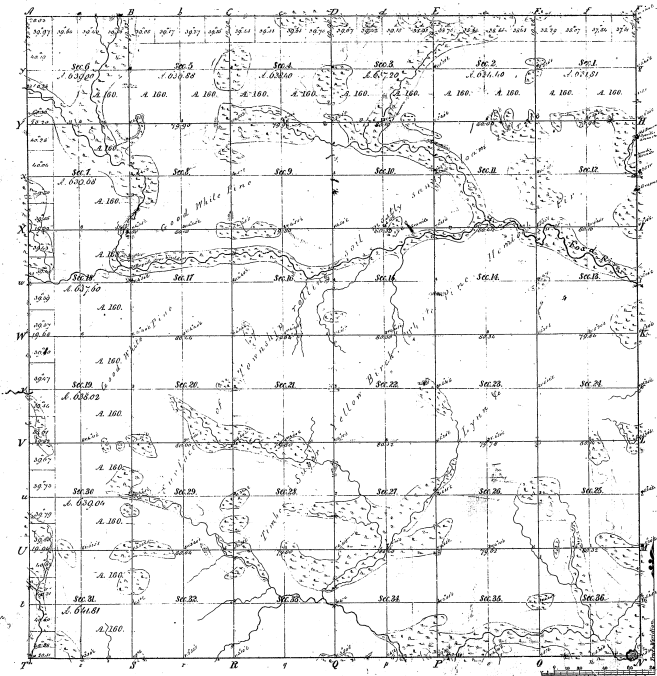

Boundaries of  
 Paid Courses 1842 Paid Courses 1842 Paid Courses 1842

45-30

45-30

Total number of Acres 2,303.66

Survey designated	By whom surveyed	Date of Contract	Amount of Survey	When Surveyed	How far out on the lot
Township lines	Wm. H. Allen	Sept. 1842	36	1842	1/2 mi.
Subdivisions	Wm. H. Allen	Jan. 25, 1842	62	1842	1/2 mi.

This above copy of Township 43 N. R. 29 W. Mer. Mich. is a true and correct copy of the original survey map as shown to the undersigned by the surveyor, and is hereby certified to be a true and correct copy of the original survey map.

Witness my hand and seal this 15th day of June 1882.

James L. Spurr, Secy.

James L. Spurr, Secy.