

Township 37° 43 N. Range 30 W. Mer. Mich.

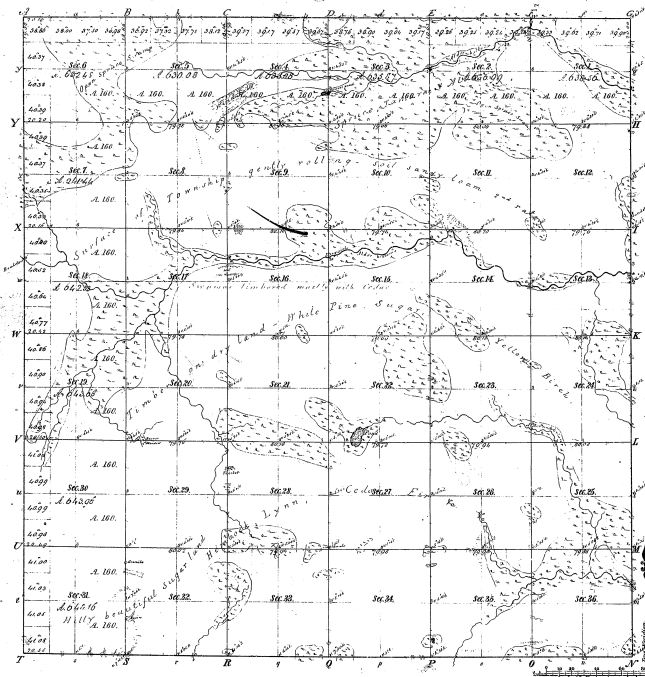

45-31

Section	Acres	Owner	Remarks
1			
2			
3			
4			
5			
6			
7			
8			
9			
10			
11			
12			
13			
14			
15			
16			
17			
18			
19			
20			
21			
22			
23			
24			
25			
26			
27			
28			
29			
30			
31			
32			
33			
34			
35			
36			

Total number of Acres 28,027.65

Survey designated	By Whom Surveyed	Date of Commencement	Amount of Survey	When Surveyed	Amount of land in the Survey
Township lines	W. H. & C. H. M.	July 7, 1864	36 Secs. 236	27	36 Secs. 236
Section lines	George Nelson	March 27, 1865	76 Secs. 231	27	76 Secs. 231

The above copy of Township 37° 43 N. Range 30 W. Mer. Mich. is a true and correct copy of the original as filed in the office of the Surveyor General and approved by the Surveyor General's Office.

Surveyor General's Office
Detroit, January 1865

Geo. W. Spurr, Secy. Genl.