

Township N. W. North, Range N. W. West (Misc. Ter.)

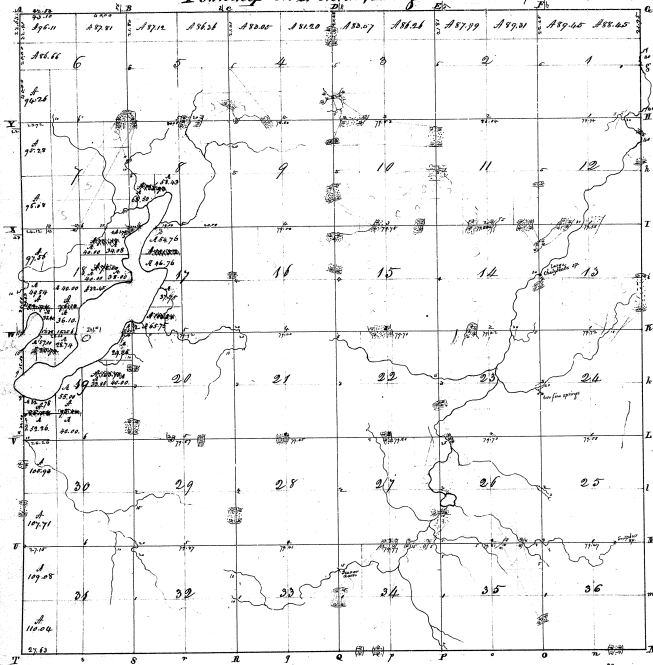

Cont

Surveyed in for 1887, by Orange Riden D.S.

Scale 6000 ft. = 1 in.

6-27

6-27

Acreage				Cubits			
Section	Area	Acres	Section	Area	Acres	Section	Area
N.W. 6	87.65	1.97	N.W. 19	101.72	2.32		
S.W. 6	80	1.82	S.W. 19	82.74	1.88		
N.E. 7	87.65	1.97	S.E. 19	85	1.93		
S.E. 7	82.00	1.87	N.W. 20	84.00	1.91		
N.E. 8	89.31	2.03	S.W. 20	80.00	1.82		
S.W. 8	80	1.82	N.E. 21	81.60	1.87		
N.E. 9	89.99	2.05	S.W. 21	80.00	1.82		
S.W. 9	80	1.82	N.E. 22	80.00	1.82		
N.E. 10	89.24	2.02	S.W. 22	80.00	1.82		
S.W. 10	80	1.82	N.E. 23	80.00	1.82		
N.E. 11	89.27	2.02	S.W. 23	80.00	1.82		
S.W. 11	80	1.82	N.E. 24	80.00	1.82		
N.E. 12	87.20	1.97	S.W. 24	80.00	1.82		
S.W. 12	80	1.82	N.E. 25	80.00	1.82		
N.E. 13	89.24	2.02	S.W. 25	80.00	1.82		
S.W. 13	80	1.82	N.E. 26	80.00	1.82		
N.E. 14	89.12	2.02	S.W. 26	80.00	1.82		
S.W. 14	80	1.82	N.E. 27	80.00	1.82		
N.E. 15	87.51	1.98	S.W. 27	80.00	1.82		
S.W. 15	80	1.82	N.E. 28	80.00	1.82		
N.E. 16	89.11	2.02	S.W. 28	80.00	1.82		
S.W. 16	80	1.82	N.E. 29	80.00	1.82		
N.E. 17	87.51	1.98	S.W. 29	80.00	1.82		
S.W. 17	80	1.82	N.E. 30	80.00	1.82		
N.E. 18	89.11	2.02	S.W. 30	80.00	1.82		
S.W. 18	80	1.82	N.E. 31	80.00	1.82		
N.E. 19	87.51	1.98	S.W. 31	80.00	1.82		
S.W. 19	80	1.82	N.E. 32	80.00	1.82		
N.E. 20	89.11	2.02	S.W. 32	80.00	1.82		
S.W. 20	80	1.82	N.E. 33	80.00	1.82		
N.E. 21	87.51	1.98	S.W. 33	80.00	1.82		
S.W. 21	80	1.82	N.E. 34	80.00	1.82		
N.E. 22	89.11	2.02	S.W. 34	80.00	1.82		
S.W. 22	80	1.82	N.E. 35	80.00	1.82		
N.E. 23	87.51	1.98	S.W. 35	80.00	1.82		
S.W. 23	80	1.82	N.E. 36	80.00	1.82		
N.E. 24	89.11	2.02	S.W. 36	80.00	1.82		
S.W. 24	80	1.82					
N.E. 25	87.51	1.98					
S.W. 25	80	1.82					
N.E. 26	89.11	2.02					
S.W. 26	80	1.82					
N.E. 27	87.51	1.98					
S.W. 27	80	1.82					
N.E. 28	89.11	2.02					
S.W. 28	80	1.82					
N.E. 29	87.51	1.98					
S.W. 29	80	1.82					
N.E. 30	89.11	2.02					
S.W. 30	80	1.82					
N.E. 31	87.51	1.98					
S.W. 31	80	1.82					
N.E. 32	89.11	2.02					
S.W. 32	80	1.82					
N.E. 33	87.51	1.98					
S.W. 33	80	1.82					
N.E. 34	89.11	2.02					
S.W. 34	80	1.82					
N.E. 35	87.51	1.98					
S.W. 35	80	1.82					
N.E. 36	89.11	2.02					
S.W. 36	80	1.82					
Total				11235.52	257.19		
Total				22921.63	522.71		

69

Island in Lake in Sec. 8, T. 18 N. R.

Township N. 4. N. Range N. 6. W. Mer. Mich.

6-27

6-27

Mount this on full sheet

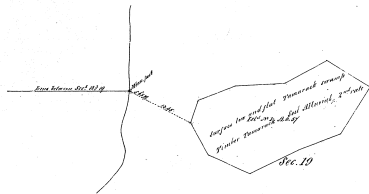

Surveyed by T. H. Wright (under Instructions May 20, 1856) on 1856. S. 8. & Classis in an Park. T. 18. N.

The above Map of Township N. 4. North of Range N. 6. West of the Principal Meridian of Michigan is truly conformable to the field notes of the Survey made in file in this Office which have been examined and approved

Surveyor General's Office  
Detroit April 20, 1857

Wm. B. Edwards  
Sur. Gen.

Exam'd by order of the  
Com. of the Land Office  
Detroit April 20, 1857