

**Re-survey**  
**Township N<sup>o</sup> 12 E**      **Range N<sup>o</sup> 1 W**      **Mer. Mich.**

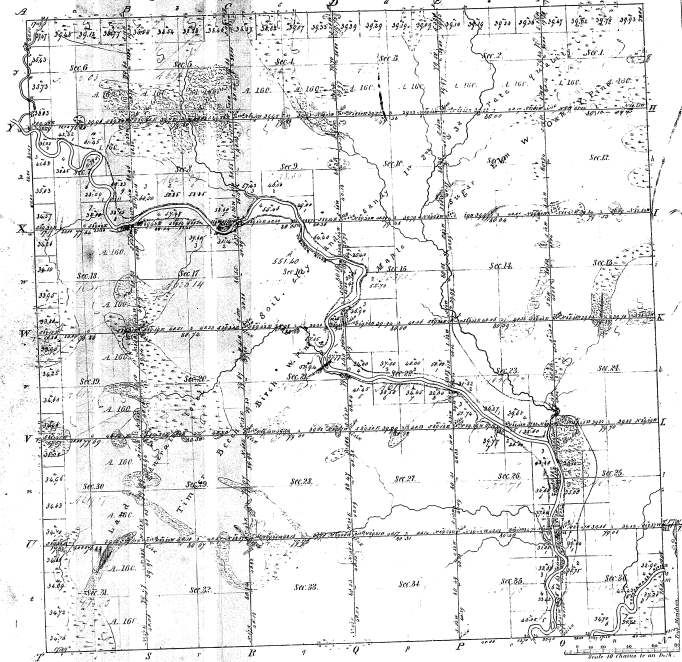

Boundaries of  
 First Course 1842-1843    Third Course 1852    Fifth Course 1852

The truth of this plot and of the Town  
 and of the measurement of the Survey

13-16

Total number of Acres 401.16			
Survey	By Whom Surveyed	Date of Contract	Amount of Acres
Township	J. C. Clark	Nov. 17 - 1842	385 1/2
Subdivisions	Francis Drake	Apr. 16 - 1852	15.68 07

The above map of Township N<sup>o</sup> 12 E of Range N<sup>o</sup> 1 W of the  
 Principal Meridian of Michigan is a true and correct copy  
 of the survey shown on file in the Office which has been examined and approved  
 by me  
 Surveyor General Office  
 Detroit 4th March 1852

Saml. Chapman  
 Surveyor