

Township 47^N. Range 36^W. Sec. Mich.

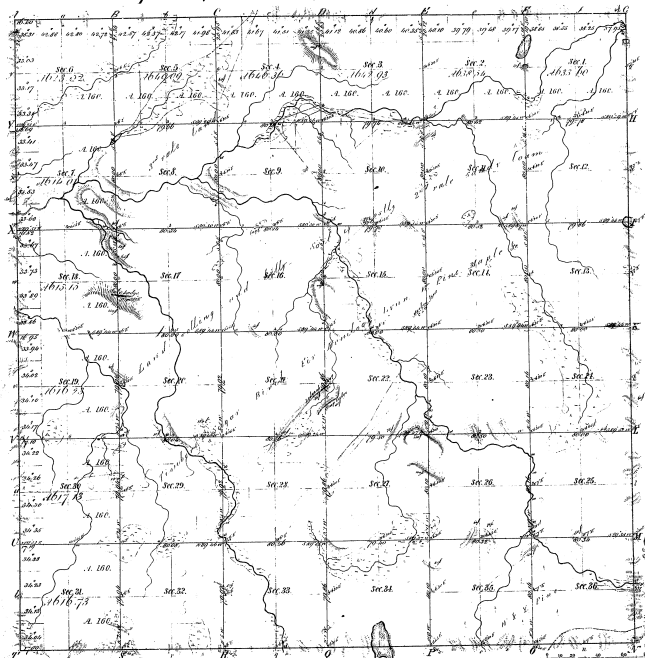

Mean Area 22
 Total Acres 22003.79
 214 = 16
 91-44

Total number of Acres 22003.79

Survey Designated	By Whom Surveyed	Date of Contract	Amount of Survey	When Surveyed	When first run and set in the Section and
Township 47 ^N	W. H. B. B. B.	April 27, 1847	36 Secs.	1846	1846
36 Sections	W. H. B. B.	June 27, 1847	36 Secs.	1846	1846

The above map of Township 47^N 36^W Mich. of Range 1³ 36^W of the Principal Meridian Michigan is a survey made to the field notes of the survey and is to be the official one hereinafter approved.

Surveyor General's Office
 Detroit June 16, 1848
 Chas. H. H.
 Surveyor Genl.