

Township N^o 51 N Range N^o 52 W

Mer. Mich.

41-6

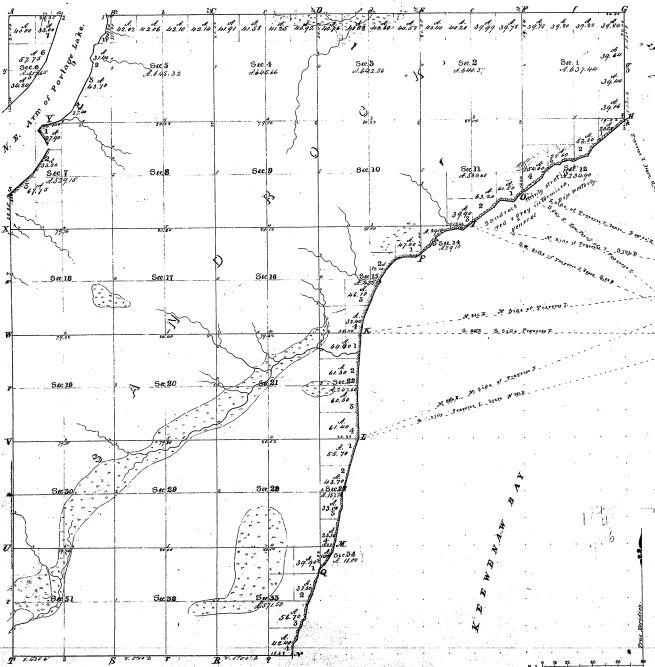

Section	Acres	Value	Section	Acres	Value
1	36.00	\$1.44	17	36.00	\$1.44
2	36.00	\$1.44	18	36.00	\$1.44
3	36.00	\$1.44	19	36.00	\$1.44
4	36.00	\$1.44	20	36.00	\$1.44
5	36.00	\$1.44	21	36.00	\$1.44
6	36.00	\$1.44	22	36.00	\$1.44
7	36.00	\$1.44	23	36.00	\$1.44
8	36.00	\$1.44	24	36.00	\$1.44
9	36.00	\$1.44	25	36.00	\$1.44
10	36.00	\$1.44	26	36.00	\$1.44
11	36.00	\$1.44	27	36.00	\$1.44
12	36.00	\$1.44	28	36.00	\$1.44
13	36.00	\$1.44	29	36.00	\$1.44
14	36.00	\$1.44	30	36.00	\$1.44
15	36.00	\$1.44	31	36.00	\$1.44
16	36.00	\$1.44	32	36.00	\$1.44
17	36.00	\$1.44	33	36.00	\$1.44
18	36.00	\$1.44	34	36.00	\$1.44
19	36.00	\$1.44	35	36.00	\$1.44
20	36.00	\$1.44	36	36.00	\$1.44

8-14

Average Improved	By Whom Surveyed	Date of Contro.	Average of Survey	From Surveyed	When Changed to the Survey
Township Area	N. W. Clark	Jan. 26, 1864	36.00	36.00	1864
Subdivisions	D. Kingston	1864	77.15	77.15	1864

The above Map of Township N^o 51 N Range N^o 52 W is correct and true according to the original survey thereof and the same has been examined and approved.
 Surveyor General's Office
 Detroit, May 8, 1864.
 Lewis J. Dyer, Secy.

215

11