

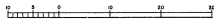

TOWNSHIP 41 NORTH, RANGE 31 WEST, OF THE MICHIGAN MERIDIAN, MICHIGAN

SURVEY OF ISLAND IN SECTION 17

45-40

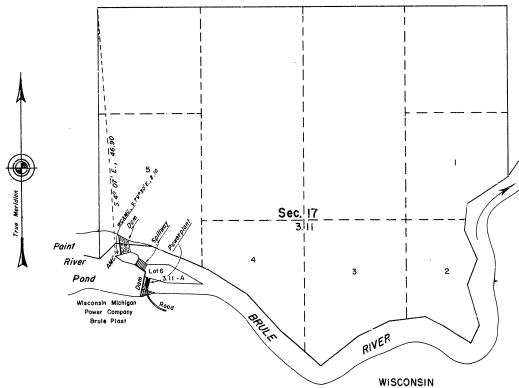

Scale in Chains

Area Surveyed 3.11 Acres.

This plat represents the survey of an island in the Brule River not previously reported on the plat of the original survey approved March 15, 1890.

This survey was executed by DeWitt A. Crain, Cadastral Surveyor, beginning October 1, 1965, and completed October 6, 1965, pursuant to Special Instructions for Group No. 71, Michigan, dated September 23, 1965.

UNITED STATES DEPARTMENT OF THE INTERIOR  
BUREAU OF LAND MANAGEMENT  
Washington, D. C. March 31, 1966

This plat is strictly conformable to the approved field notes, and the survey, having been correctly executed in accordance with the requirements of law and the regulations of this Bureau, is hereby accepted.

For the Director

*E. A. [Signature]*  
Chief, Division of Engineering