

Township N. 12 South, Range N. 11 West 4th. (Mic. Ter.)

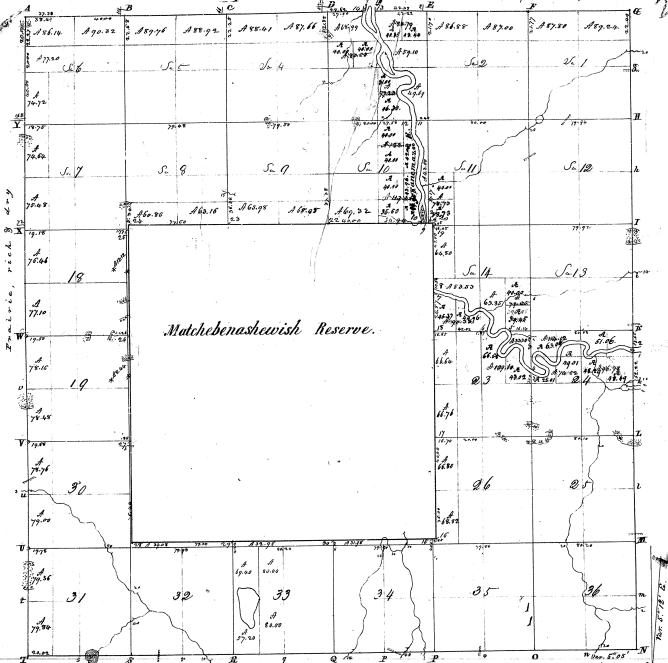

Surveyed in January 1877 by John Mallett & S.

Section		Acreage		Value	
1/4	17 1/2	39	2.0	78	17
1/4	18	39	2.0	78	17
1/4	19	39	2.0	78	17
1/4	20	39	2.0	78	17
1/4	21	39	2.0	78	17
1/4	22	39	2.0	78	17
1/4	23	39	2.0	78	17
1/4	24	39	2.0	78	17
1/4	25	39	2.0	78	17
1/4	26	39	2.0	78	17
1/4	27	39	2.0	78	17
1/4	28	39	2.0	78	17
1/4	29	39	2.0	78	17
1/4	30	39	2.0	78	17
1/4	31	39	2.0	78	17
1/4	32	39	2.0	78	17
1/4	33	39	2.0	78	17
1/4	34	39	2.0	78	17
1/4	35	39	2.0	78	17
1/4	36	39	2.0	78	17
1/2	17 1/2	78	4.0	156	34
1/2	18	78	4.0	156	34
1/2	19	78	4.0	156	34
1/2	20	78	4.0	156	34
1/2	21	78	4.0	156	34
1/2	22	78	4.0	156	34
1/2	23	78	4.0	156	34
1/2	24	78	4.0	156	34
1/2	25	78	4.0	156	34
1/2	26	78	4.0	156	34
1/2	27	78	4.0	156	34
1/2	28	78	4.0	156	34
1/2	29	78	4.0	156	34
1/2	30	78	4.0	156	34
1/2	31	78	4.0	156	34
1/2	32	78	4.0	156	34
1/2	33	78	4.0	156	34
1/2	34	78	4.0	156	34
1/2	35	78	4.0	156	34
1/2	36	78	4.0	156	34
3/4	17 1/2	117	6.0	234	51
3/4	18	117	6.0	234	51
3/4	19	117	6.0	234	51
3/4	20	117	6.0	234	51
3/4	21	117	6.0	234	51
3/4	22	117	6.0	234	51
3/4	23	117	6.0	234	51
3/4	24	117	6.0	234	51
3/4	25	117	6.0	234	51
3/4	26	117	6.0	234	51
3/4	27	117	6.0	234	51
3/4	28	117	6.0	234	51
3/4	29	117	6.0	234	51
3/4	30	117	6.0	234	51
3/4	31	117	6.0	234	51
3/4	32	117	6.0	234	51
3/4	33	117	6.0	234	51
3/4	34	117	6.0	234	51
3/4	35	117	6.0	234	51
3/4	36	117	6.0	234	51
1	17 1/2	156	8.0	312	68
1	18	156	8.0	312	68
1	19	156	8.0	312	68
1	20	156	8.0	312	68
1	21	156	8.0	312	68
1	22	156	8.0	312	68
1	23	156	8.0	312	68
1	24	156	8.0	312	68
1	25	156	8.0	312	68
1	26	156	8.0	312	68
1	27	156	8.0	312	68
1	28	156	8.0	312	68
1	29	156	8.0	312	68
1	30	156	8.0	312	68
1	31	156	8.0	312	68
1	32	156	8.0	312	68
1	33	156	8.0	312	68
1	34	156	8.0	312	68
1	35	156	8.0	312	68
1	36	156	8.0	312	68
1 1/2	17 1/2	234	12.0	468	102
1 1/2	18	234	12.0	468	102
1 1/2	19	234	12.0	468	102
1 1/2	20	234	12.0	468	102
1 1/2	21	234	12.0	468	102
1 1/2	22	234	12.0	468	102
1 1/2	23	234	12.0	468	102
1 1/2	24	234	12.0	468	102
1 1/2	25	234	12.0	468	102
1 1/2	26	234	12.0	468	102
1 1/2	27	234	12.0	468	102
1 1/2	28	234	12.0	468	102
1 1/2	29	234	12.0	468	102
1 1/2	30	234	12.0	468	102
1 1/2	31	234	12.0	468	102
1 1/2	32	234	12.0	468	102
1 1/2	33	234	12.0	468	102
1 1/2	34	234	12.0	468	102
1 1/2	35	234	12.0	468	102
1 1/2	36	234	12.0	468	102
2	17 1/2	312	16.0	624	136
2	18	312	16.0	624	136
2	19	312	16.0	624	136
2	20	312	16.0	624	136
2	21	312	16.0	624	136
2	22	312	16.0	624	136
2	23	312	16.0	624	136
2	24	312	16.0	624	136
2	25	312	16.0	624	136
2	26	312	16.0	624	136
2	27	312	16.0	624	136
2	28	312	16.0	624	136
2	29	312	16.0	624	136
2	30	312	16.0	624	136
2	31	312	16.0	624	136
2	32	312	16.0	624	136
2	33	312	16.0	624	136
2	34	312	16.0	624	136
2	35	312	16.0	624	136
2	36	312	16.0	624	136
3	17 1/2	390	20.0	780	168
3	18	390	20.0	780	168
3	19	390	20.0	780	168
3	20	390	20.0	780	168
3	21	390	20.0	780	168
3	22	390	20.0	780	168
3	23	390	20.0	780	168
3	24	390	20.0	780	168
3	25	390	20.0	780	168
3	26	390	20.0	780	168
3	27	390	20.0	780	168
3	28	390	20.0	780	168
3	29	390	20.0	780	168
3	30	390	20.0	780	168
3	31	390	20.0	780	168
3	32	390	20.0	780	168
3	33	390	20.0	780	168
3	34	390	20.0	780	168
3	35	390	20.0	780	168
3	36	390	20.0	780	168
4	17 1/2	470	24.0	940	201
4	18	470	24.0	940	201
4	19	470	24.0	940	201
4	20	470	24.0	940	201
4	21	470	24.0	940	201
4	22	470	24.0	940	201
4	23	470	24.0	940	201
4	24	470	24.0	940	201
4	25	470	24.0	940	201
4	26	470	24.0	940	201
4	27	470	24.0	940	201
4	28	470	24.0	940	201
4	29	470	24.0	940	201
4	30	470	24.0	940	201
4	31	470	24.0	940	201
4	32	470	24.0	940	201
4	33	470	24.0	940	201
4	34	470	24.0	940	201
4	35	470	24.0	940	201
4	36	470	24.0	940	201
5	17 1/2	550	28.0	1100	240
5	18	550	28.0	1100	240
5	19	550	28.0	1100	240
5	20	550	28.0	1100	240
5	21	550	28.0	1100	240
5	22	550	28.0	1100	240
5	23	550	28.0	1100	240
5	24	550	28.0	1100	240
5	25	550	28.0	1100	240
5	26	550	28.0	1100	240
5	27	550	28.0	1100	240
5	28	550	28.0	1100	240
5	29	550	28.0	1100	240
5	30	550	28.0	1100	240
5	31	550	28.0	1100	240
5	32	550	28.0	1100	240
5	33	550	28.0	1100	240
5	34	550	28.0	1100	240
5	35	550	28.0	1100	240
5	36	550	28.0	1100	240
6	17 1/2	630	32.0	1260	273
6	18	630	32.0	1260	273
6	19	630	32.0	1260	273
6	20	630	32.0	1260	273
6	21	630	32.0	1260	273
6	22	630	32.0	1260	273
6	23	630	32.0	1260	273
6	24	630	32.0	1260	273
6	25	630	32.0	1260	273
6	26	630	32.0	1260	273
6	27	630	32.0	1260	273
6	28	630	32.0	1260	273
6	29	630	32.0	1260	273
6	30	630	32.0	1260	273
6	31	630	32.0	1260	273
6	32	630	32.0	1260	273
6	33	630	32.0	1260	273
6	34	630	32.0	1260	273
6	35	630	32.0	1260	273
6	36	630	32.0	1260	273
7	17 1/2	710	36.0	1420	308
7	18	710	36.0	1420	308
7	19	710	36.0	1420	308
7	20	710	36.0	1420	308
7	21	710	36.0	1420	308
7	22	710	36.0	1420	308
7	23	710	36.0	1420	308
7	24	710	36.0	1420	308
7	25	710	36.0	1420	308
7	26	710	36.0	1420	308
7	27	710	36.0	1420	308
7	28	710	36.0	1420	308
7	29	710	36.0	1420	308
7	30	710	36.0	1420	308
7	31	710	36.0	1420	308
7	32	710	36.0	1420	308
7	33	710	36.0	1420	308
7	34	710	36.0	1420	308
7	35	710	36.0	1420	308
7	36	710	36.0	1420	308
8	17 1/2	790	40.0	1580	343
8	18	790	40.0	1580	343
8	19	790	40.0	1580	343
8	20	790	40.0	1580	343
8	21	790	40.0	1580	343
8	22	790	40.0	1580	343
8	23	790	40.0	1580	343
8	24	790	40.0	1580	343
8	25	790	40.0	1580	343
8	26	790	40.0	1580	343
8	27	790	40.0	1580	343
8	28	790	40.0	1580	343
8	29				

Township 1st N. 2nd South, Range 1st W. 1st West Mer. (Mic. Ter.)

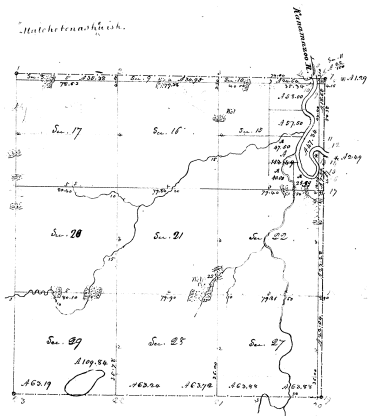

Section	Area	Area
17	8	27 38
18	9	30 28
19	10	24 26
20	11	7 59
21	12	18 68
22	13	47 36
23	14	20 29
24	15	58 22
25	16	57 22
26	17	115 49
27	18	220
28	19	640
29	20	640
30	21	640
31	22	640
32	23	23 28
33	24	22 24
34	25	28 0
35	26	50 1
36	27	63 28
37	28	63 22
38	29	220
39	30	80
40	31	63 20
41	32	80 00
42	33	63 24
43	34	220
44	35	159 24
45	36	86
46	37	63 17
Total		3752 60

2-5

Surveyed in June 1889 by Orange Hinton, S.S.

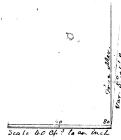

T. 2 S. R. 11 W. Mich

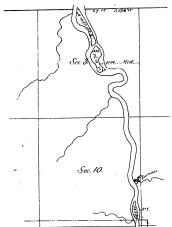

Surveyed in 1880 by Thomas Murphy, Surveyor General

The above diagram of islands in the Kalamazoo
 River in T. 2 S. R. 11 W. is hereby confirmed with the field
 notes of the same on file in this office
 Surveyor General's Office
 Detroit, August 29 1870
 Charles S. Hill
 Surveyor General

2-5

2-5 ③