

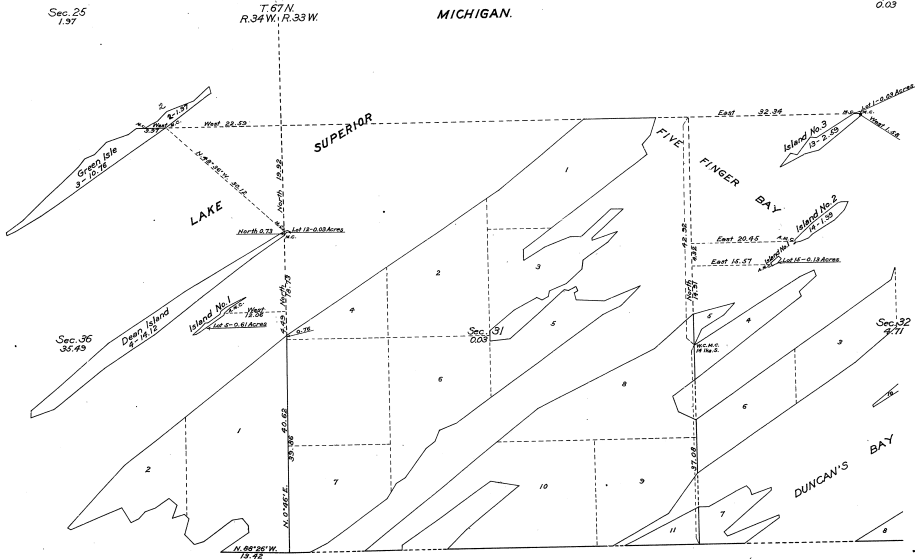

**PLAT OF SIX ISLANDS**  
 In the Isle Royale Group, Lake Superior,  
 in Sections 25 and 36, T. 67 N., R. 34 W.,

and  
 Sections 29, 31 and 32, T. 67 N., R. 33 W., Michigan Meridian,  
**MICHIGAN.**



The undersigned hereby certifies that the survey delineated upon this plat has been executed under his general direction and in accordance with the approved Special Instructions issued pursuant to authority contained in office letter 47870-25920-48350-48351-48354 \*P. J. M., dated April 15, 1917, addressed to the Secretary of the Interior (approved April 15, 1917), and letter dated April 30, 1917, addressed to the undersigned, and that the field notes and plat of the survey have been carefully verified.

Washington, D. C.,  
 March 27, 1900.

*A. D. Fisher*  
 Associate Supervisor of Surveys.

**Legend.**

Scale : 10 chains to an Inch.

Surveyed by Lester L. Clement, U. S. Surveyor, from August 14 to 28, 1917, inclusive, under Special Instructions dated July 30, 1917, issued by A. D. Fisher, Supervisor of Surveys, which were approved by the Commissioner of the General Land Office on July 26, 1917.

DEPARTMENT OF THE INTERIOR  
 GENERAL LAND OFFICE  
 Washington, D. C., March 31, 1900.

The above plat of six islands in the Isle Royale Group, Lake Superior, in Sections 25 and 36, T. 67 N., R. 34 W., and Sections 29, 31 and 32, T. 67 N., R. 33 W., Michigan Meridian, Michigan, is strictly conformable to the field notes of the survey thereof, on file in this office, which have been examined and approved.

*[Signature]*  
 Commissioner and ex-officio U. S. Surveyor General  
 for Michigan.

40-212