

Township 1st 44th N. Range 1st 7th W.

Mer. Mich.

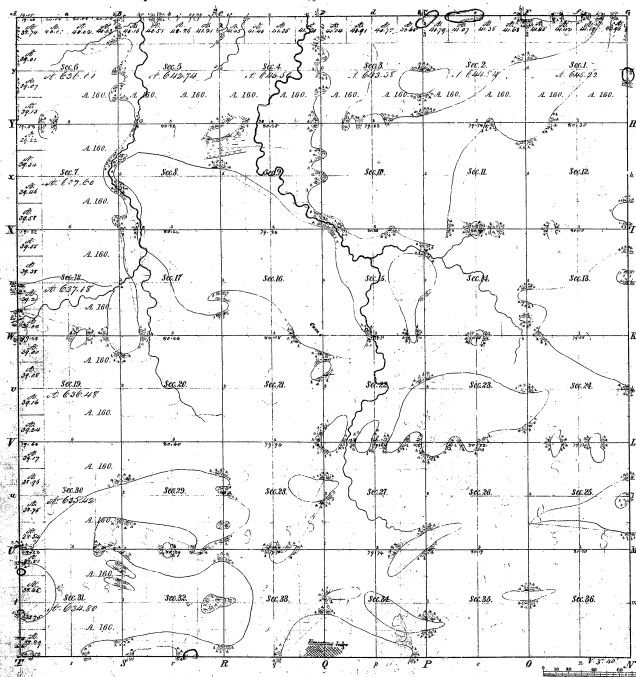

Total number of Acres 23632.17

| Survey Designated | By Whom Surveyed | Date of Contract | Amount of Survey | When Surveyed | Class of Land |
|-------------------|------------------|---------------------------|------------------|---------------------------------------|---------------|
| Township lines | J. H. Dyer | Aug 18 th 1821 | 36 | 1822 | 113.6 |
| Subdivisions | John A. Dyer | Feb 12 th 1845 | 66.00 | 22 nd 3 rd 1845 | |

The above Map of Township 1st 44th North of Range 1st 7th West of the
 Principal Meridian Michigan is a true and correct copy of the field notes
 of the survey thereon on file in the office, and the same have remained unaltered.

Surveyor General's Office
 Detroit, Sept 1st 1855

Lucius Lyon, Surveyor

Measures of
 Public Courses 1/2nd and 3/4th of a Mile.

| |
|-------|
| 34-34 |
| 124 |
| 1725 |
| 520 |
| 737 |

34-34