

124174

**Plat of Goose Island**

in Goose Lake

in Secs. 26 and 35, T. 23 N. R. 8 W., Mich. Mer.,

MICHIGAN.

Surveyed by J. G. Cavanaugh, U.S. Deputy Surveyor, Aug. 16<sup>th</sup> and 17<sup>th</sup> 1909,  
under special instructions from the Comr. G.L.O., bearing date Aug. 4, 1909.

Scale 10 chs. to an inch.

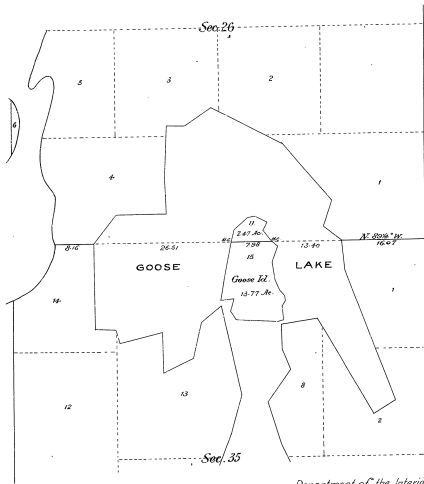

C.C.

Department of the Interior,  
General Land Office,  
Washington, D.C., Jan. 4, 1910.

The above plat of Goose Island in Goose Lake in Secs. 26 and 35, T. 23 N., R. 8 W., Mich. Meridian, Michigan, is a correct plat of a survey executed by J. G. Cavanaugh, U.S. Deputy Surveyor, in pursuance of special instructions from the Commissioner of the General Land Office, bearing date Aug. 4, 1909, and is strictly conformable to the field notes of the survey thereof on file in this office, which have been examined and approved.

*Paul D. ...*  
Commissioner and Ex-officio  
U.S. Surveyor General for Michigan.

15-32

1532