

T. 51. N. R. 29 W T. 51. N. R. 28 W
Township 50 N Range 29 W Mer.

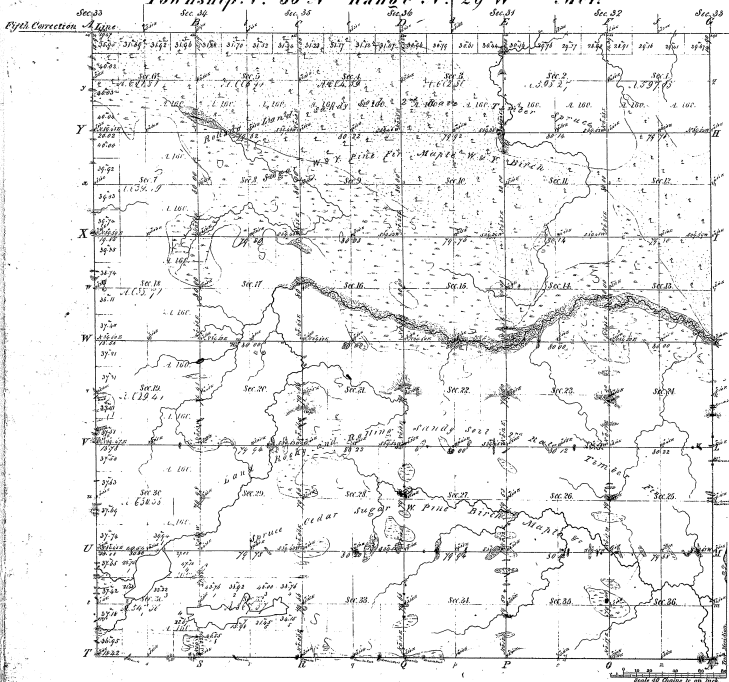

Boundaries of
 Public Lands (1842) (1848) (1854) (1860) (1866) (1872) (1878) (1884) (1890) (1896) (1902) (1908) (1914) (1920) (1926) (1932) (1938) (1944) (1950) (1956) (1962) (1968) (1974) (1980) (1986) (1992) (1998) (2004) (2010) (2016) (2022)

115-4

115-4

45-4

Total number of Acres 22,000 35

Survey Designated	By Whom Surveyed	Date of Contract	Amount of Survey	When Surveyed	Plan of the land and all the Surveyed
Township lines	W. C. Probstman & Co	April 7 1846	36 36 46	24	24
Sub-divisions	A. B. Wood	Nov 18	83 78 78	24	24

The above Map of Township 50 N. R. 29 W. Meridian is strictly conformable to the field notes of the survey thereon, and the same have been examined and approved.

Surveyor General's Office,
 Detroit August 10 1852

Severide Ed. Governor