

Township N. 20 N., Range N. 7 W., Sec. 20.

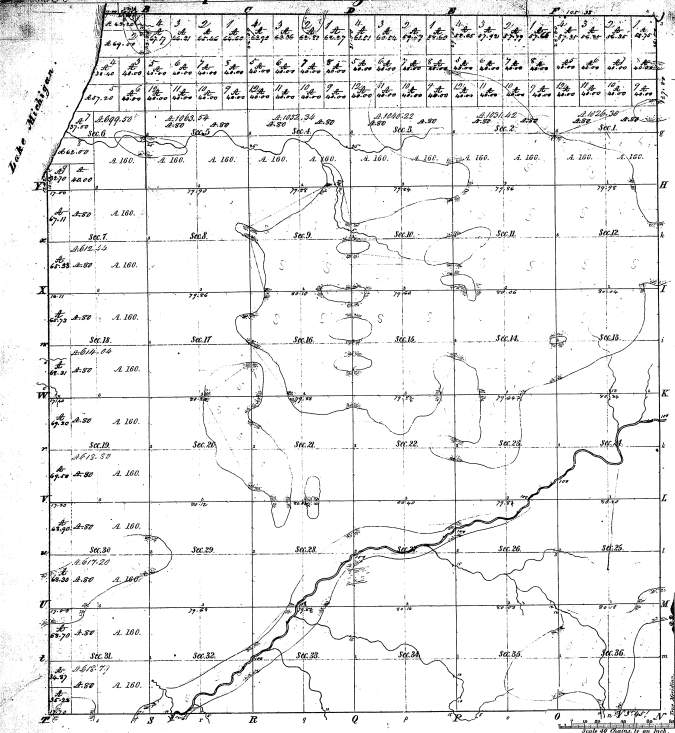

9-2
 Remarks: Bl. 17 1/2

Measure of Acres.			
Point	Course	Dist.	Area
1	N 77° 00' W	100.00	100.00
2	S 77° 00' E	100.00	100.00
3	N 77° 00' W	100.00	100.00
4	S 77° 00' E	100.00	100.00
5	N 77° 00' W	100.00	100.00
6	S 77° 00' E	100.00	100.00
7	N 77° 00' W	100.00	100.00
8	S 77° 00' E	100.00	100.00
9	N 77° 00' W	100.00	100.00
10	S 77° 00' E	100.00	100.00
11	N 77° 00' W	100.00	100.00
12	S 77° 00' E	100.00	100.00
13	N 77° 00' W	100.00	100.00
14	S 77° 00' E	100.00	100.00
15	N 77° 00' W	100.00	100.00
16	S 77° 00' E	100.00	100.00
17	N 77° 00' W	100.00	100.00
18	S 77° 00' E	100.00	100.00
19	N 77° 00' W	100.00	100.00
20	S 77° 00' E	100.00	100.00
21	N 77° 00' W	100.00	100.00
22	S 77° 00' E	100.00	100.00
23	N 77° 00' W	100.00	100.00
24	S 77° 00' E	100.00	100.00
25	N 77° 00' W	100.00	100.00
26	S 77° 00' E	100.00	100.00
27	N 77° 00' W	100.00	100.00
28	S 77° 00' E	100.00	100.00
29	N 77° 00' W	100.00	100.00
30	S 77° 00' E	100.00	100.00
31	N 77° 00' W	100.00	100.00
32	S 77° 00' E	100.00	100.00
33	N 77° 00' W	100.00	100.00
34	S 77° 00' E	100.00	100.00
35	N 77° 00' W	100.00	100.00
36	S 77° 00' E	100.00	100.00

9-2

Total number of Acres 24,876.57

Survey designated	By whom surveyed	Date of Contract	Amount of Survey when Surveyed	When Surveyed	Area in Acres
Original Survey	Wm. H. H. H.	11/17/1837	16 3/4 Secs	1837	1638
Subdivisions	Wm. H. H.	11/18/37	66 1/2 Secs	1837	1139
W. H. H.	Wm. H. H.	11/24/36	5 1/2 Secs	1837	1139

The above copy of Township N. 20 North of Range N. 7 West of the Principal Meridian Michigan is truly and conformable to the field notes of the survey thereon for the this office has been examined and approved.
 George Conant, Surveyor General
 Conant's Sup. N. 1139
 P. P. P. P.