

Township No. 36 N. Range No. 28 W. Mer. Mich.

(57)

47-16

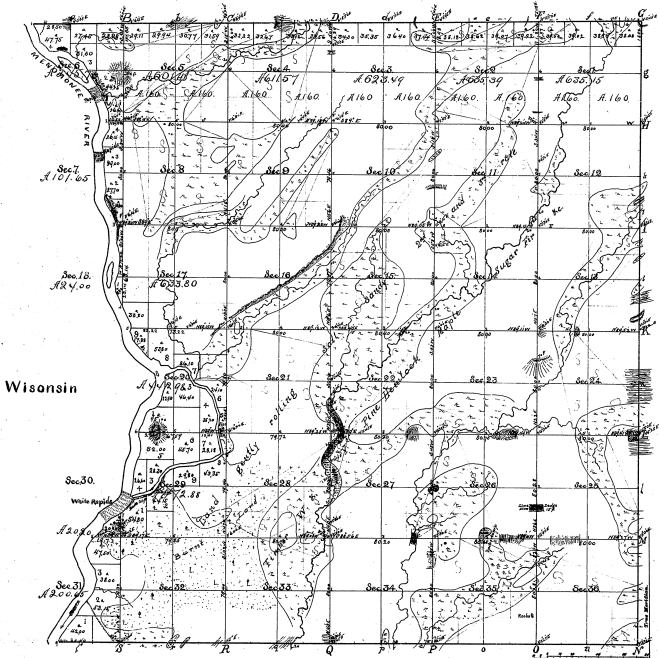

Mounds of					
Foot	Corner	Ch. Aka.	Foot	Ch. Aka.	Foot

Quantity of miles 05 Chas. 24 Lines

I certify that this plat is a true copy of the Original Government plat on file in this Office.  
 State Land Office }  
 Lansing Mich. Dec. 26<sup>th</sup> 1853 } *Wm. H. Stenoh*  
 Comptroller

Total Number of Acres, A. 19,327.90

Survey Disposition	By Whom Surveyed	Date of Grant	Acres	Width	Width of Survey	Width of Section
Township Lines	John Mullett	June 26, 1847	11	24	34	37 <sup>th</sup> Dec. 1848
Subdivisions	Francis Coleman	April 12, 1852	62	10	62	37 <sup>th</sup> Dec. 1852

The above Map of Township No. 36 N. of Range No. 28 West of the Principal Meridian Michigan, is strictly conformable to the field notes of the survey thereof on file in this office, which has been examined and approved  
 Surveyor General's Office,  
 Detroit, October 10, 1853

*Sander Chapman*  
 Surveyor General.

Township 1° 36' N. Range 1° 28' W. Mer. 11ch.

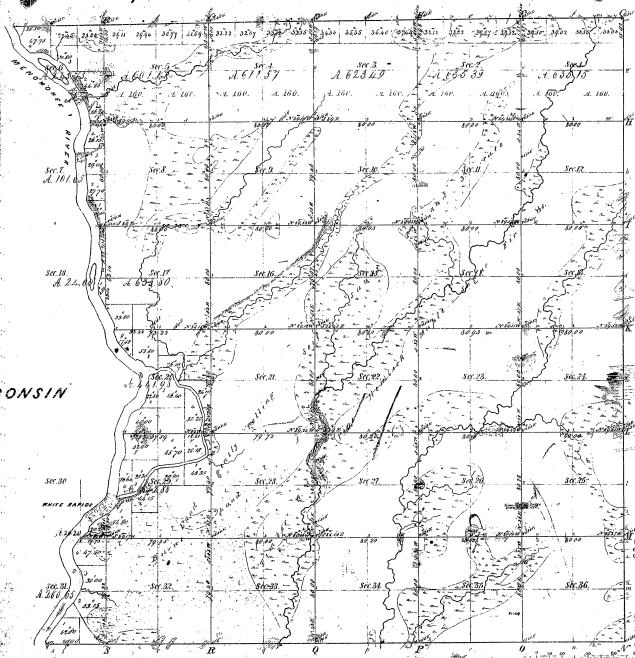

WISCONSIN

Boundaries of  
 First Townships 1842, First Townships 1842, First Townships 1842

H 116

Mount Good Hill, 1842

47-16

Total number of Acres 10,327.9

Acres	Number of Acres	Value of Acres	Amount of Interest	When Acquired	Value of Interest
10,327.9	10,327.9	10,327.9	10,327.9	1842	10,327.9

The above map of Township 1° 36' North of Range 1° 28' West of the Principal Meridian of Wisconsin is a study conformable to the first notes of the Survey of the said Township and Range and has been examined and approved by the Surveyor General of Wisconsin.

Surveyor General