

Township 1° 38' N Range 1° 26' W Mer. Mich.

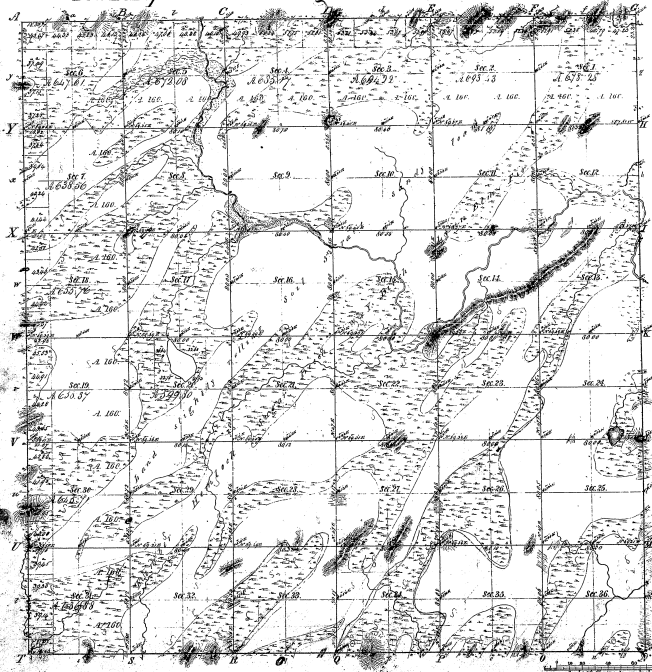

Total number of Acres, 28,800.57

Survey designated	By whom surveyed	Date of Contract	Amount of Survey	When Surveyed	Acres Contained
1854	Wm. H. H. H.	1854	100	1854	100
1855	Wm. H. H. H.	1855	100	1855	100
1856	Wm. H. H. H.	1856	100	1856	100
1857	Wm. H. H. H.	1857	100	1857	100
1858	Wm. H. H. H.	1858	100	1858	100
1859	Wm. H. H. H.	1859	100	1859	100
1860	Wm. H. H. H.	1860	100	1860	100
1861	Wm. H. H. H.	1861	100	1861	100
1862	Wm. H. H. H.	1862	100	1862	100
1863	Wm. H. H. H.	1863	100	1863	100
1864	Wm. H. H. H.	1864	100	1864	100
1865	Wm. H. H. H.	1865	100	1865	100
1866	Wm. H. H. H.	1866	100	1866	100
1867	Wm. H. H. H.	1867	100	1867	100
1868	Wm. H. H. H.	1868	100	1868	100
1869	Wm. H. H. H.	1869	100	1869	100
1870	Wm. H. H. H.	1870	100	1870	100
1871	Wm. H. H. H.	1871	100	1871	100
1872	Wm. H. H. H.	1872	100	1872	100
1873	Wm. H. H. H.	1873	100	1873	100
1874	Wm. H. H. H.	1874	100	1874	100
1875	Wm. H. H. H.	1875	100	1875	100
1876	Wm. H. H. H.	1876	100	1876	100
1877	Wm. H. H. H.	1877	100	1877	100
1878	Wm. H. H. H.	1878	100	1878	100
1879	Wm. H. H. H.	1879	100	1879	100
1880	Wm. H. H. H.	1880	100	1880	100

The above copy of Township 1° 38' N of Range 1° 26' W of the Principal Meridian of Michigan is hereby confirmed to the field notes of the survey of the above township and range, and approved.

Wm. H. H. H.  
Surveyor General

Samuel Chapman  
Notary

47-A

47-4

Minutes of a  
Public Conference of the  
Public Conference of the  
Public Conference of the  
Public Conference of the

Handwritten notes in the table:

Handwritten notes in the table: