

*RESURVEY*  
 Township 1° 22' N Range 1° 5' W Ver. Mich.

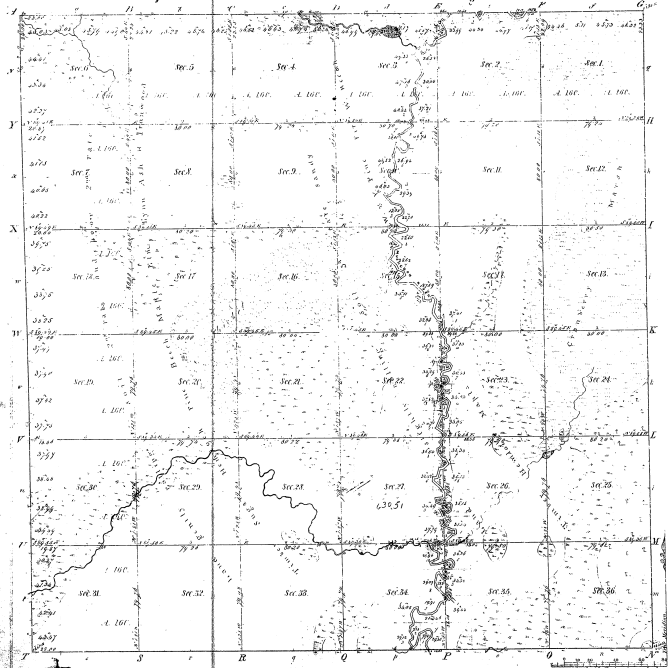

Boundaries of  
 Grid courses of 100' Grid courses 1800' Grid courses 1800'

|  |  |  |  |  |  |
|--|--|--|--|--|--|
|  |  |  |  |  |  |
|--|--|--|--|--|--|

15-36

Total number of Acres 53,534

| Survey described | By whom surveyed | Date of contract | Amount of survey | When last sold | Money for and use of |
|------------------|------------------|------------------|------------------|----------------|----------------------|
| For sale lots    | John Brown       | Sept 27 1838     | 1,200            | 1840           | for the use of the   |
| Subdivision      | James Brown      | Sept 27 1838     | 1,200            | 1840           | for the use of the   |

The above map of Township 1° 22' N of Range 1° 5' W of the Principal Meridian is a survey conformable to the field notes of the survey thereof on file in this Office, which have been examined and approved.

Surveyor General's Office  
 Detroit August 1858  
*David Chapman*  
 Surveyor