

Re survey
Township 17° 21' N: Range 17° E East. Mer. Mich.

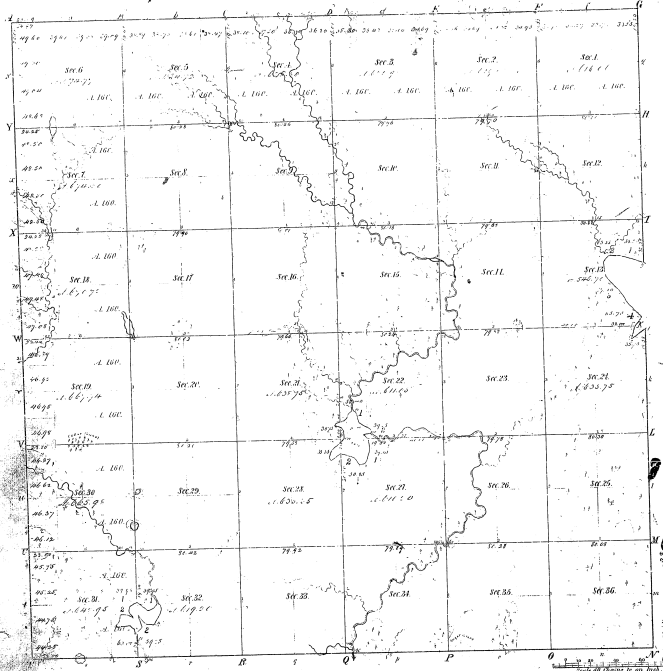

Boundaries of
Public Courses 1852 Public Courses 1854 Public Courses 1856

21	110
----	-----

21-40

Total number of Acres 22632.94

Survey designated	By whom surveyed	Date of completion	Amount of Survey	When surveyed	How filed and in what office
Public Lands	Edmund A. Farnell	July 16, 1857	22 632.94	1857	in the Survey Office
Public Lands	J. B. Banta	July 11, 1856	22 632.94	1856	in the Survey Office

The above Map of Township 17° 21' N. & E. of R. Principal Meridian, Mich. is as shown is strictly conformable to the field notes of the survey kept on file in this Office, which have been examined and approved.

Surveyor General's Office
Detroit, July 28, 1866
Lucius Lyon, Surveyor