

T.34N. R.44W. T.34N. R.44W.

Township 35° 50' N. Range 44° W. Mer. Mich.

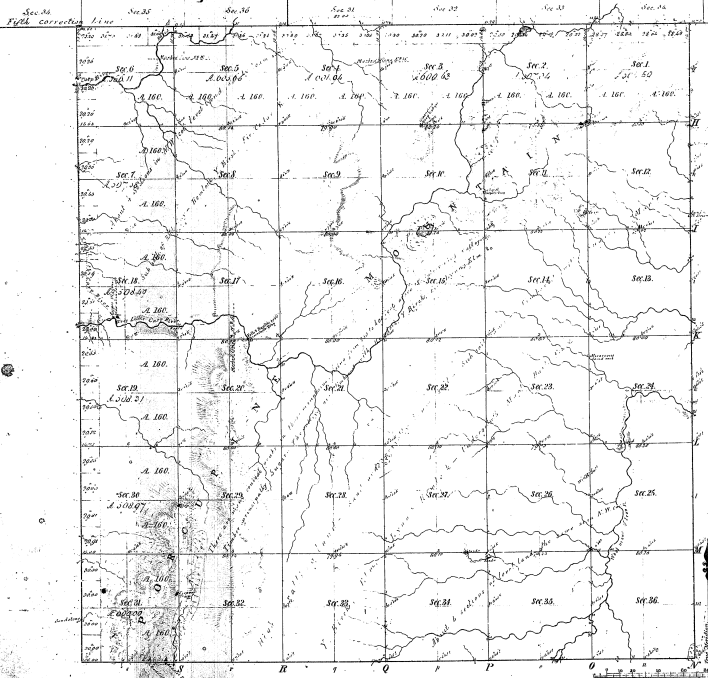

Sec. 36	Sec. 35	Sec. 34	Sec. 33	Sec. 32	Sec. 31	Sec. 30

42-3

42-3

Total number of Acres, 2,250.00

Survey designated	By whom surveyed	Date of Contract	Amount of Survey	When Surveyed	When Surveyed
Township lines	W.C. Anderson	March 27, 1847	36	1847	1847
Subdivisions	And. For. and B. King's land		89.26	1847	1847

The above map of Township 35° 50' North of Range 44° West of the Principal Meridian, Michigan, is a correct representation of the field notes of the survey thereof as filed in this office, which have been examined and approved.

Surveyor General's Office,  
Detroit, Mich. B. May.

Leicester Lyons, Surveyor.