

Resurvey

Township 1° 30' N. Range 1° 2' W. Mer. Mich.

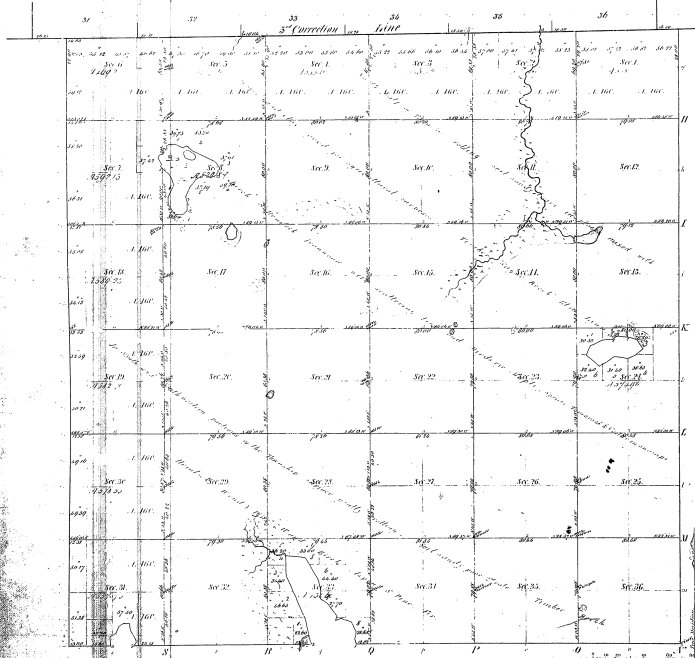

Meanders of
 State Course 1841 State Course 1842 State Course 1843

14-3

14-3

Total number of Acres 21,876.25

Survey completed	By Whom Surveyed	Date of Contract	Amount of Survey	When Surveyed	Money paid and by Whom
1843	James H. McMillan	October 20 th 1843	11 1/2 1/2	1843	1000
1844	J. H. McMillan	July 1 st 1844	10 1/2 1/2	1844	1000

The above Map of Township 1° 30' North of Range 1° 2' West of the Principal Meridian Michigan is truly conformable to the field notes of the survey thereof on file in this office which have been examined and approved.

Surveyor General's Office
 St. Paul August 1847
 J. L. Cassano
 Secy. Genl.

Some of the computed acreages on the
W line of the township appear to be
in error.

JB 6/7/76