

Township N. W. North. Range N. W. West Mer. (Mc. Tor.)

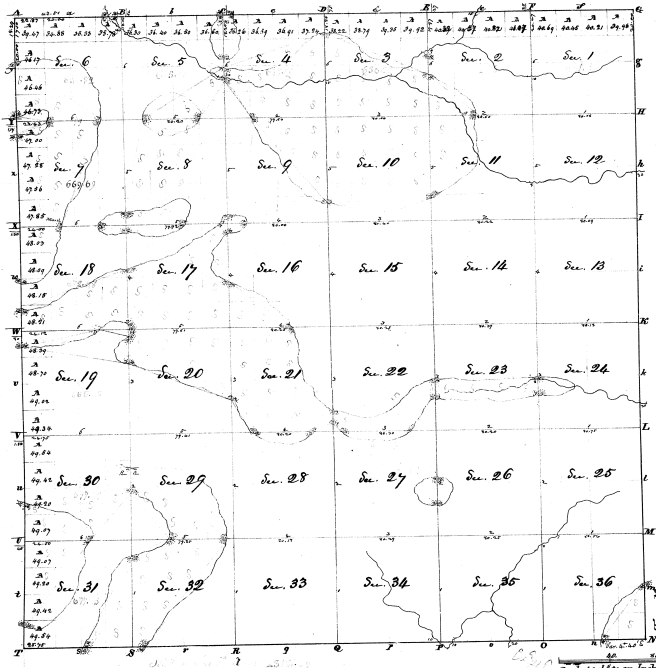

| County | Com. & Div. | 12. Nov. 1833 | 25 | 60. 16. 30 | Apr. 1833 | 2: 1833 |
|----------|-------------|---------------|----|------------|-----------|---------|
| Orange | A. B. B. B. | | | | | |
| Division | C. B. B. B. | | | | | |

The above Map of Township N. W. North of Range N. W. West of the Meridian, which is thirty Congress Lots to the North, is the Survey thereof, and is in the Office of the Surveyor General, and is approved.

Surveyor General's Office
Washington, 16th & 4th, 1833

M. T. Williams
Secy.

614

8-19