

R.W.

Township N. VIII North, Range N. XII West Mer. (Mic. Ter.)

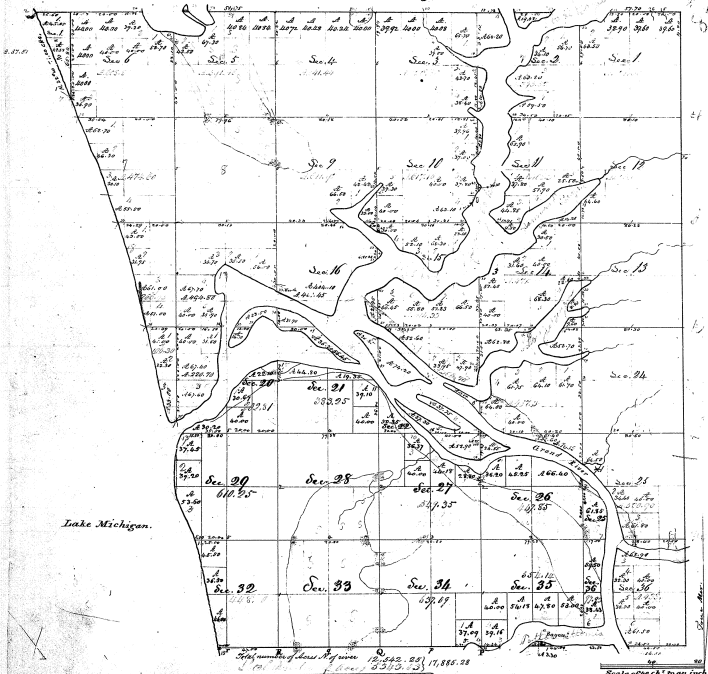

Acres of Bayou	Measure of Grass	Measure of Grass	Measure of Grass	Measure of Grass
20	12.50	12.50	12.50	12.50
21	12.50	12.50	12.50	12.50
22	12.50	12.50	12.50	12.50
23	12.50	12.50	12.50	12.50
24	12.50	12.50	12.50	12.50
25	12.50	12.50	12.50	12.50
26	12.50	12.50	12.50	12.50
27	12.50	12.50	12.50	12.50
28	12.50	12.50	12.50	12.50
29	12.50	12.50	12.50	12.50
30	12.50	12.50	12.50	12.50
31	12.50	12.50	12.50	12.50
32	12.50	12.50	12.50	12.50
33	12.50	12.50	12.50	12.50
34	12.50	12.50	12.50	12.50
35	12.50	12.50	12.50	12.50
36	12.50	12.50	12.50	12.50

Survey	Section	Acres	Value
1	1	12.50	12.50
2	2	12.50	12.50
3	3	12.50	12.50
4	4	12.50	12.50
5	5	12.50	12.50
6	6	12.50	12.50
7	7	12.50	12.50
8	8	12.50	12.50
9	9	12.50	12.50
10	10	12.50	12.50
11	11	12.50	12.50
12	12	12.50	12.50
13	13	12.50	12.50
14	14	12.50	12.50
15	15	12.50	12.50
16	16	12.50	12.50
17	17	12.50	12.50
18	18	12.50	12.50
19	19	12.50	12.50
20	20	12.50	12.50
21	21	12.50	12.50
22	22	12.50	12.50
23	23	12.50	12.50
24	24	12.50	12.50
25	25	12.50	12.50
26	26	12.50	12.50
27	27	12.50	12.50
28	28	12.50	12.50
29	29	12.50	12.50
30	30	12.50	12.50
31	31	12.50	12.50
32	32	12.50	12.50
33	33	12.50	12.50
34	34	12.50	12.50
35	35	12.50	12.50
36	36	12.50	12.50

The above table of Sections N. VIII North, Range N. XII West Mer. of this Township Michigan Sec. is Shall be made to the field notes of the Survey thereof, and file in this office which have been examined and approved.

Surveyor General's Office
 M. T. Murray
 1853

