

County of St. Clair

Township N<sup>o</sup> 2N Range N<sup>o</sup> 16E Mer. Mich.

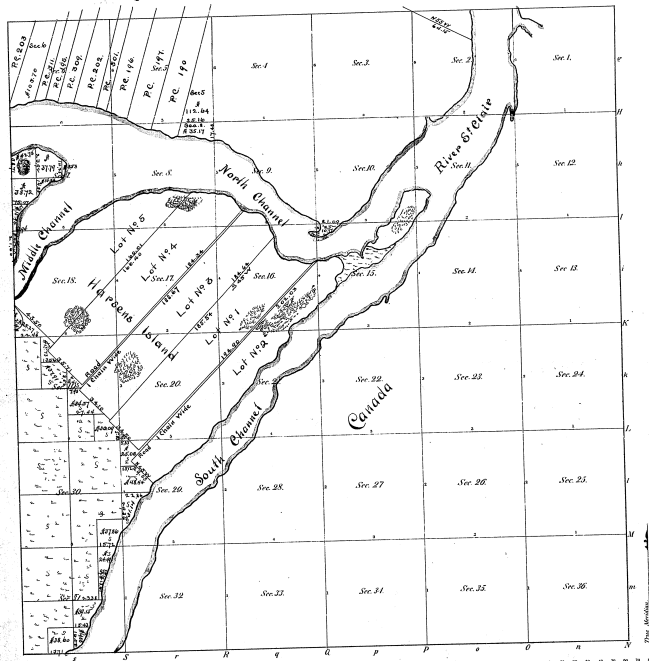

Surveyed in 1847, by H.D. Bartholomew Deputy Surveyor.  
 This plat is strictly in conformity  
 with the field notes of the survey  
 and is hereby approved  
 Roscoe D. Dix

I certify that the above is a true copy of the  
 plat on this office.  
 Roscoe D. Dix  
 Michigan State Land Office  
 Lansing May 31 1849

December 31 1849

Commissioner State Land Office

26-AD  
 Commissioner

County of St Clair

Township 1<sup>o</sup> 2<sup>n</sup> N. Range 1<sup>o</sup> 16 E. Mer. Mich.

96.400  
6.2

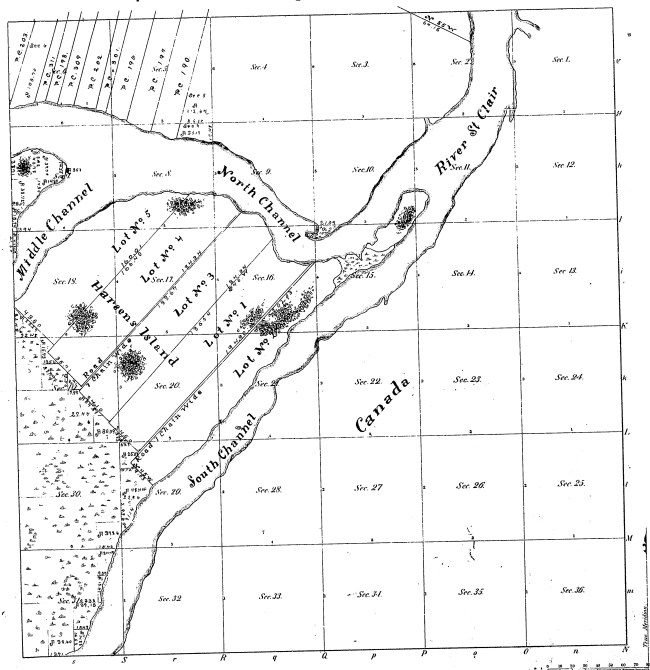

Surveyed in 1852, by H. D. Bartholomew - Deputy Surveyor

This plot is strictly in conformity  
with the field notes of the survey  
and is truly affirmed

Received

Commissioner State Land Office

I certify that the above is a true copy of the  
plot in this Office.  
Michigan State Land Office  
 Lansing 27<sup>th</sup> Feb 1870

Received

Received 31 1870

(184)

STATE OF MICHIGAN,

STATE LAND OFFICE.

OFFICIAL CERTIFICATE.

Lansing, October 18<sup>th</sup> 1898.

I, Arthur P. Doornick, Deputy Commissioner of the State  
Land Office, do hereby certify that the annexed is a true copy of  
the plat of the Parkman Survey of Township  
27<sup>th</sup> North, Range 16 East 3<sup>rd</sup> East.

That I have carefully compared the said copy with the original  
thereof now on file and of record in my office, and that it is a  
correct transcript therefrom and of the whole thereof.

In Testimony Whereof, I have hereunto sub-  
scribed my name and have caused the  
Seal of this office to be affixed.

Done at the city of Lansing on the  
day and year above written.

Arthur P. Doornick  
Commissioner of the State Land Office.

Township N. 2 North Range N. 4 W. East of Mer. Michigan Territory

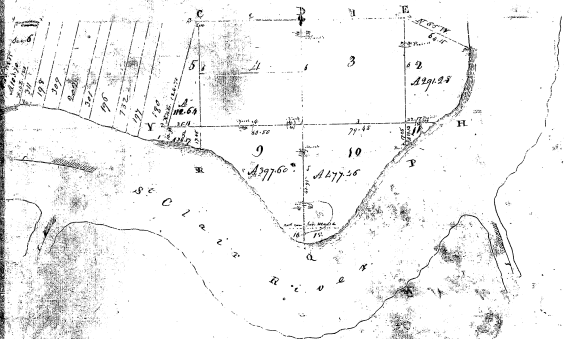

Pursuant to a contract with and Instructions from Edward Tiffin Esquire  
Surveyor General of the United States bearing date the 20th day of November 1816 I have  
admeasured laid out and surveyed the above describe Township and hereby certify that it  
had such marks and bounds both natural and artificial as are represented on said plat  
and described in the well and made thereof and returned with this plat into the Surveyor  
Generals office on the 18th day of February 1818.

William Fisher, Esq.

26-40

26-40

727, 116E.

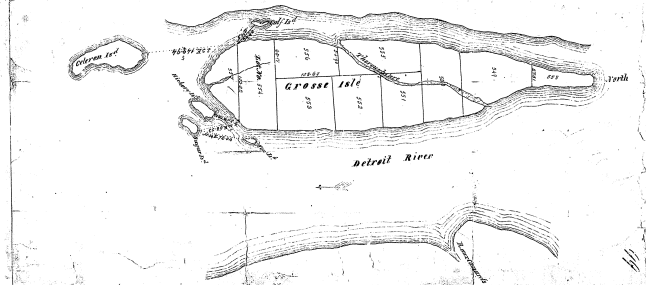
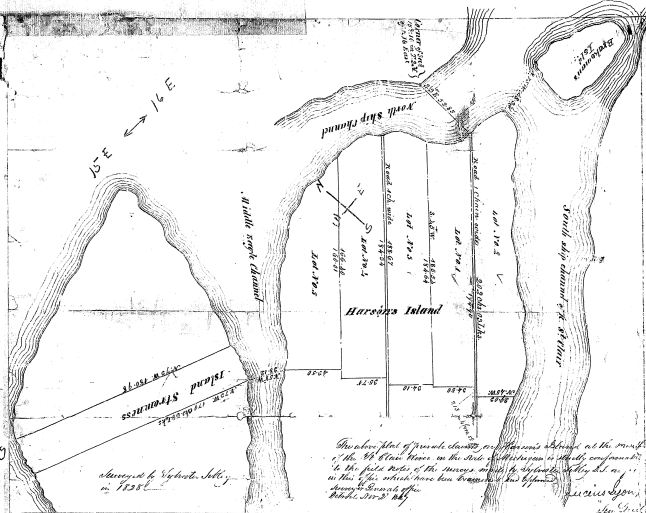

9h  
26-40  
HE - 9/10