

Township 1<sup>st</sup> 44 N. Range 1<sup>st</sup> 15 W. Mer. Mich.

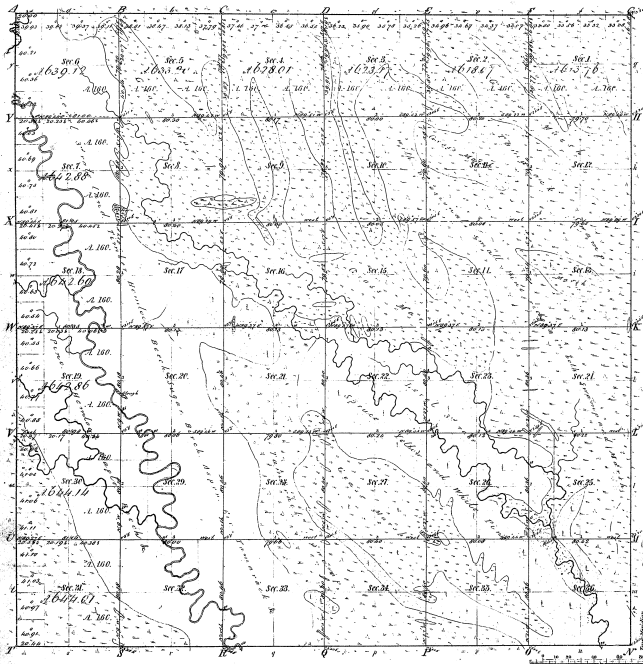

Total number of Acres 22071.01

Survey Designated	By Whom Surveyed	Date of Instrument	Amount of Survey	When Surveyed	Showing Acres and Fractions (for Section 36)
Township lots	W. A. Board	April 4 1841	36 36 1/2		1348.12500000
Subdivisions	D. S. Corwin	May 12 1850	60 31 1/2		2458.87500000

The above copy of Township 1<sup>st</sup> 44 North of Range 1<sup>st</sup> 15 West of the Principal Meridian Michigan is hereby approved to the first notes of the survey thereof on file in this office which have been examined and approved.

Surveyor General's Office  
Detroit Feb. 18 1851

Charles A. White  
Sur. Genl.

Mentions of		Prob. Census 1810	Prob. Census 1820	Prob. Census 1830	Prob. Census 1840
36	25				

36-25