

Return

Township 12 1/2 N. Range 10 W. Mer. Mich.

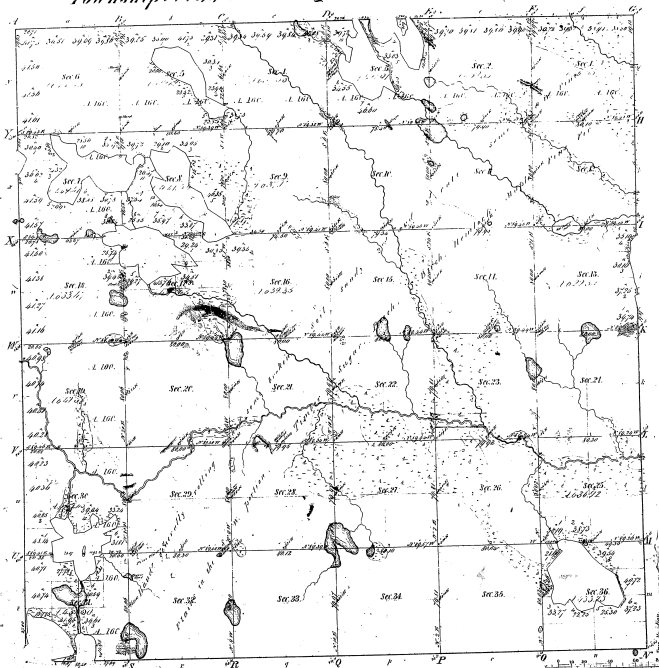

Members of
State Congress 1848 Public Session 1848

3128

37-22

March 20th 1848

Total number of Acres 21632.64

Survey Designated	By Whom Surveyed	Date of Contract	Amount of Survey	When Surveyed	How far and in what direction from the Section Corner
Township Lines	J. B. Davis	April 1st 1841	36 1/2 Secs	1841	
Subdivisions	Geo. S. Adams	April 27th 1842	36 1/2 Secs	1842	

The above Map of Township 12 1/2 N. Range 10 W. Mer. Mich. is a true and correct copy of the original plat of the survey thereon on file in the office, and has been examined and approved by the Survey General's Office.

Survey General's Office
Dubuque, Iowa, May 21, 1868

Seaman C. Johnson, Surveyor General

State of Iowa
May 21, 1868