

Township N. 11. South, Range T. 12. East of Mer. (M. 112)

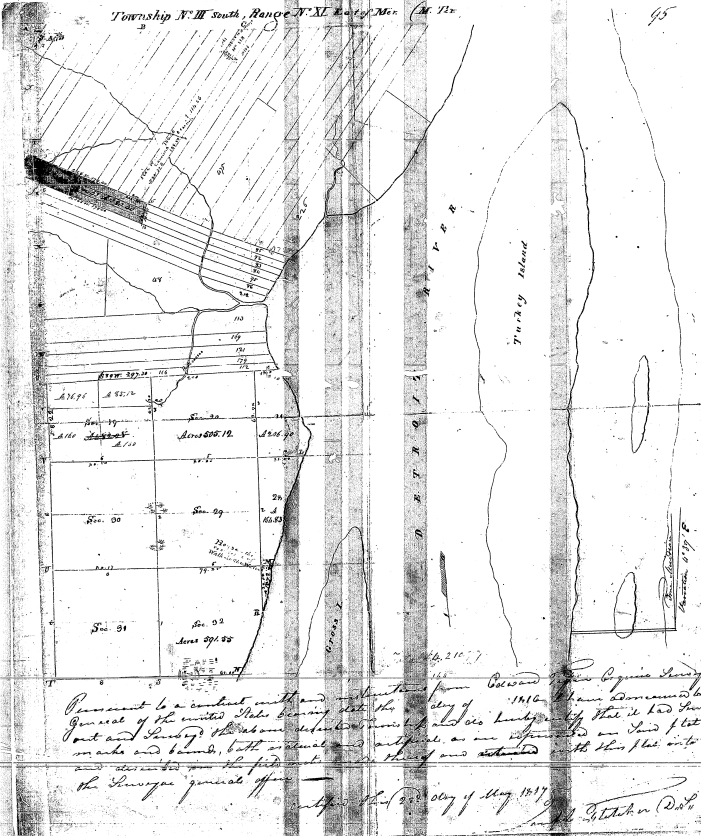

32-35
 32-35
 32-35

6,210.7
 Comment to be submitted with and submitted from General John Ogden Lewis
 General of the United States Army with the city of 1846. I have examined the
 Court and Lewis of the National Archives and find his handwriting to be that of
 words and bounds, both original and authentic, as are attested on this flat
 and described from the field to the office of said attested with this flat with
 the Surveyor General's office
 attested this 20th day of May 1817
 J. C. Johnson

TOWNSHIP 3 SOUTH, RANGE 11 EAST, OF THE MICHIGAN MERIDIAN, MICHIGAN
RESURVEY OF GRASSY AND MAMMY JUDA ISLANDS

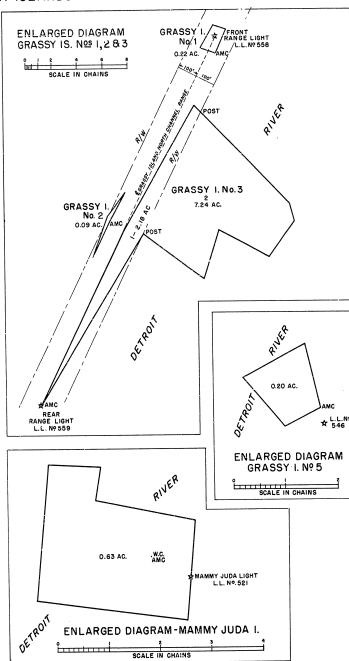
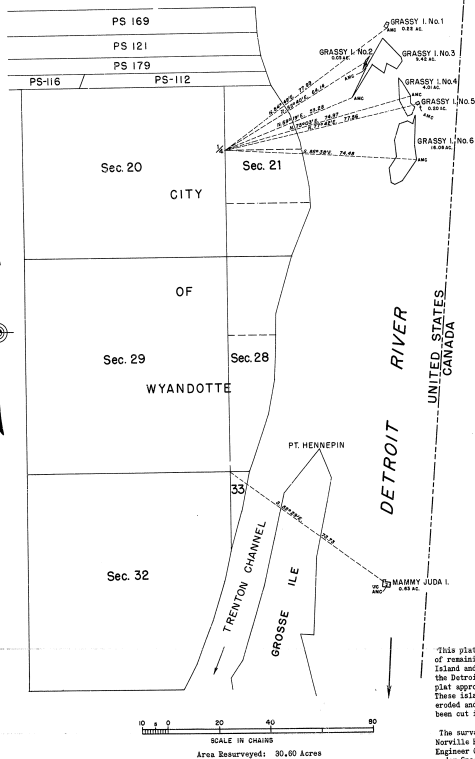

This plat represents resurvey of remaining portions of Grassy Island and Mammy Juda Island in the Detroit River as shown on plat approved September 29, 1845. These islands have been badly eroded and Grassy Island has been cut into a group of 5 islands.

The survey was executed by Norville S. Shearer, Coastal Engineer October 2 to 6, 1952, under Special Instructions for Group 59, Michigan, dated September 17, 1952.

UNITED STATES DEPARTMENT OF THE INTERIOR
BUREAU OF LAND MANAGEMENT
Washington, D. C., May 21, 1953

This plat is strictly conformable to the approved field notes, and the survey, having been correctly conducted in accordance with the requirement of law and the regulations of this Bureau, is hereby accepted.

For the Administrator
James C. Bennett
Assistant Chief, Division of
Coastal Engineering

SUPPLEMENTAL PLAT

T. 3 S., R. 11 E., Michigan Mer.

MICHIGAN.

Scale: 20 chains to an inch.

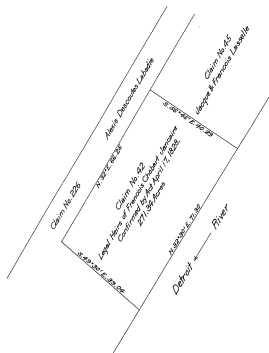

32-35
④

Department of the Interior
General Land Office,
Washington, D.C., October-30, 1918.

The above plat of claim No. 42, Legal Hours of Francis Chas. Luceau, T. 3 S., R. 11 E., Michigan Meridian, Michigan, is strictly conformable to the field notes of the survey thereof, executed by Sylvester Sibby, D. S., in January 1825, on file in this office and is hereby approved.

Commissioner and ex officio
U.S. Surveyor General for Michigan.