

Re-Survey

Township N^o 21 N. Range N^o 11 W. Mex. Mich.

Note:

The Blue Lines indicate the position of corners of all sections lying on the old survey, which could be found.

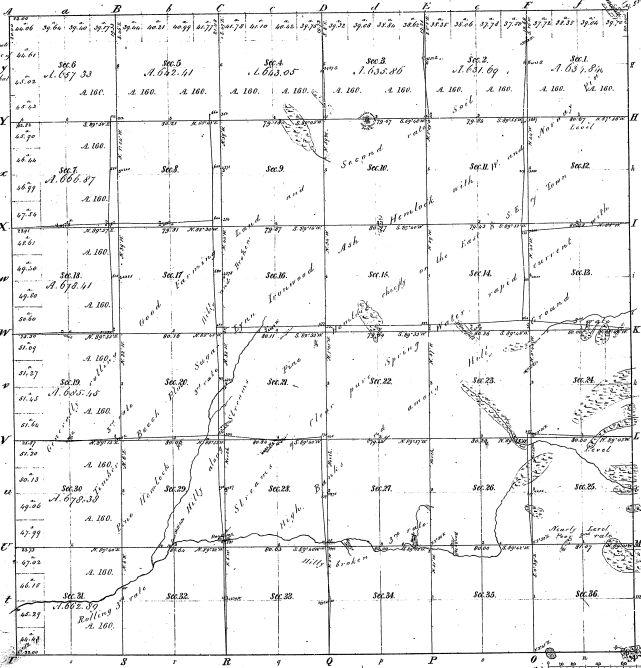

Boundaries of
Public Courses 1822-1825 Courses 1826-1828 Courses 1829-1832

16-39					
-------	--	--	--	--	--

16-39

Total number of Acres 23217.18

Survey designated	By whom surveyed	Date of Contract	Amount of Survey	When surveyed	Who for and for what
Township lines	John D. Smith	1822	36	1822	for the Govt
Subdivisions	James G. Brown	1822	23217.18	1822	for the Govt

The above map of Township N^o 21 North of Range N^o 11 West of the Principal Meridian Michigan, is a strictly conformable to the field notes of the survey thereof on file in this Office, which have been examined, and approved.

Surveyor General's Office
Detroit, Nov. 1, 1875

Correct copy made
P. J. ...

Lucius Lyon, Sur. Gen.