

# Resurvey

**Township 35 35.1 Range 22 E. Mer. Mich.**

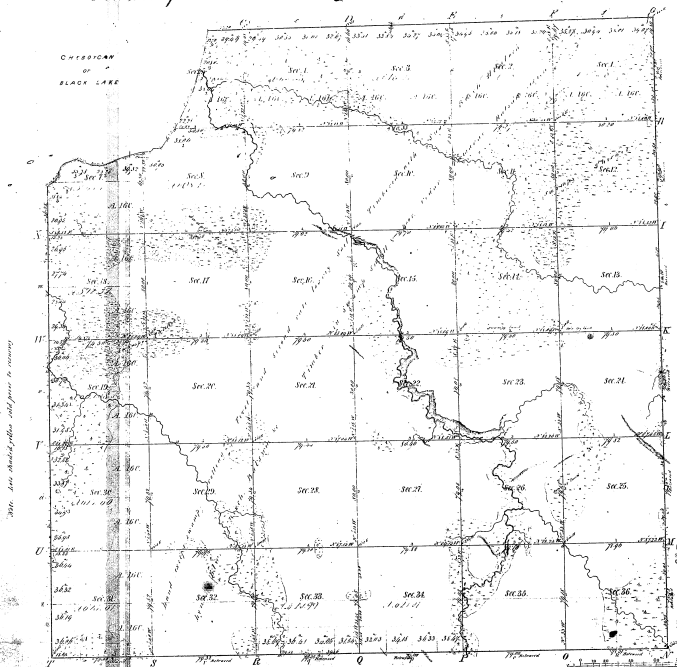

Total number of Acres 21,523.53

| Survey description | By whom surveyed | Date of finished        | Amount of Survey | When surveyed            | When made and set in the field |
|--------------------|------------------|-------------------------|------------------|--------------------------|--------------------------------|
| Original Survey    | John H. Bowman   | Feb 25 1855             | 21 523 53        | 3 <sup>d</sup> June 1855 |                                |
| Subdivision        | Geo. H. Coe      | Oct 3 <sup>d</sup> 1855 | 19 56 72         | 2 <sup>d</sup> Oct 1855  |                                |

The above copy of Township 35 35.1 North of Range 22 East Principal Meridian of Michigan is a true and correct copy of the survey thereof as it is in the files which have been examined and approved.

Surveyor General of Michigan  
 Robert S. Johnson  
 Secy. Mich. Dep't of Agr.

Boundaries of  
 State Township 35 35.1 North of Range 22 East of Michigan

19-40

19-40