

S2-B-P

R-9  
U. S. Department of Agriculture  
Forest Service  
LAKE AND STREAM SURVEY  
GOVERNMENT LAKE  
Manistee National Forest  
Michigan

Location Sec. 27 T18N. R13W.  
Scale 16" = 1 Mile

Area 22.5 Acres  
Length of Shoreline .78 Miles

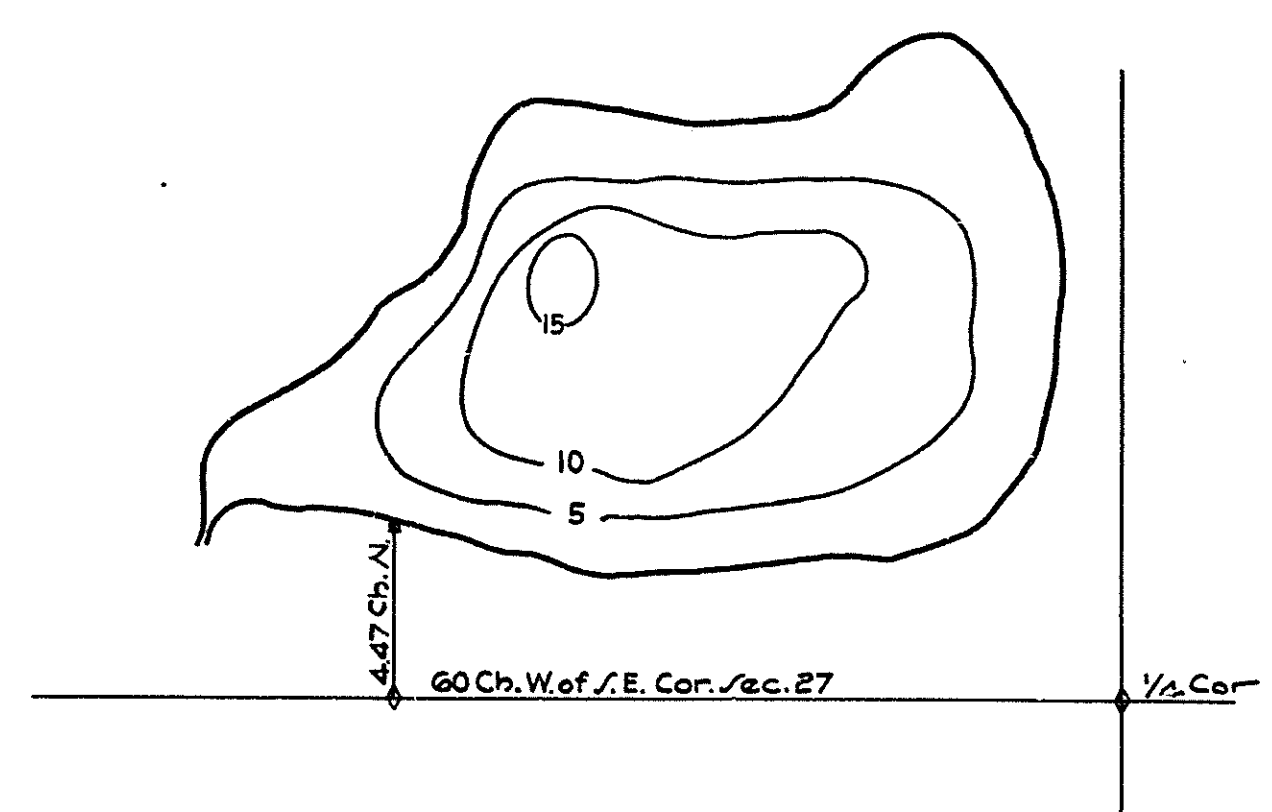

Contour Map  
Contour Interval 5'

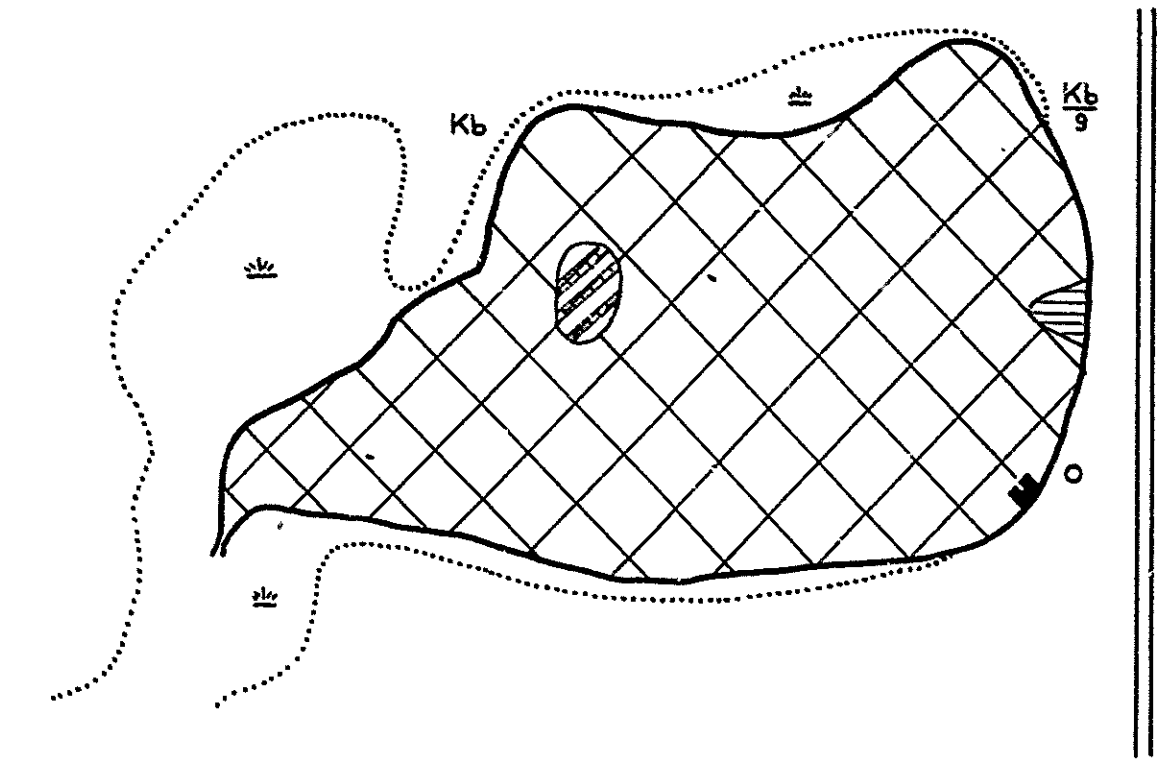

Cover Type and  
Lake Bottom/Soil Type Map

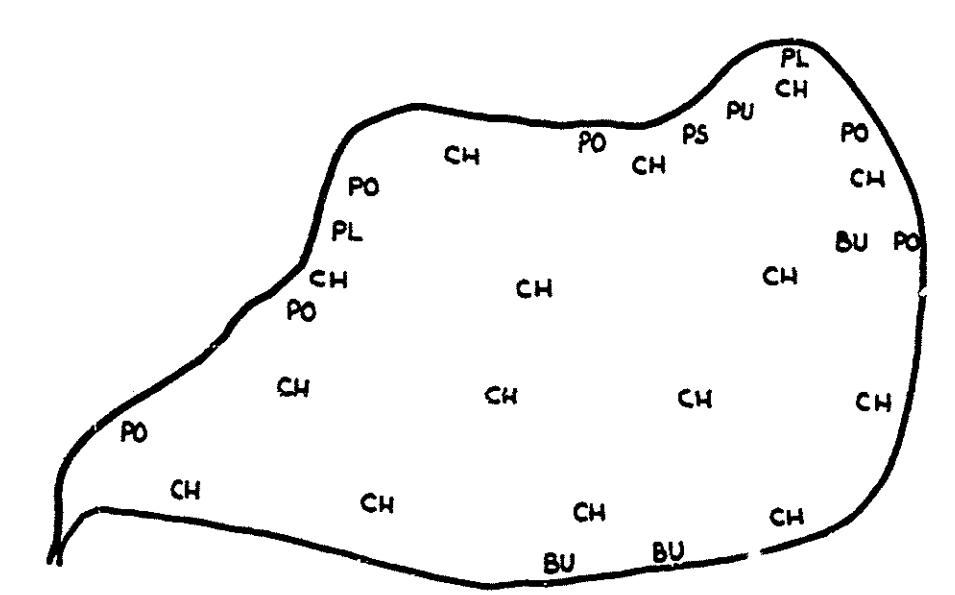

Aquatic Vegetation Map

J-8-25