

INSTITUTE FOR FISHERIES RESEARCH  
 DIVISION OF FISHERIES MICHIGAN CONSERVATION DEPT  
 LAKE INVENTORY MAP  
**HELEN LAKE**  
 AREA 115 ACRES  
 MARGINAL SURVEY AND SOUNDINGS BY  
 LAKE & STREAM IMPROVEMENT SECTION 2/20-23/61  
 MARQUETTE COUNTY T.45N., R.29W., SEC'S. 3, 4

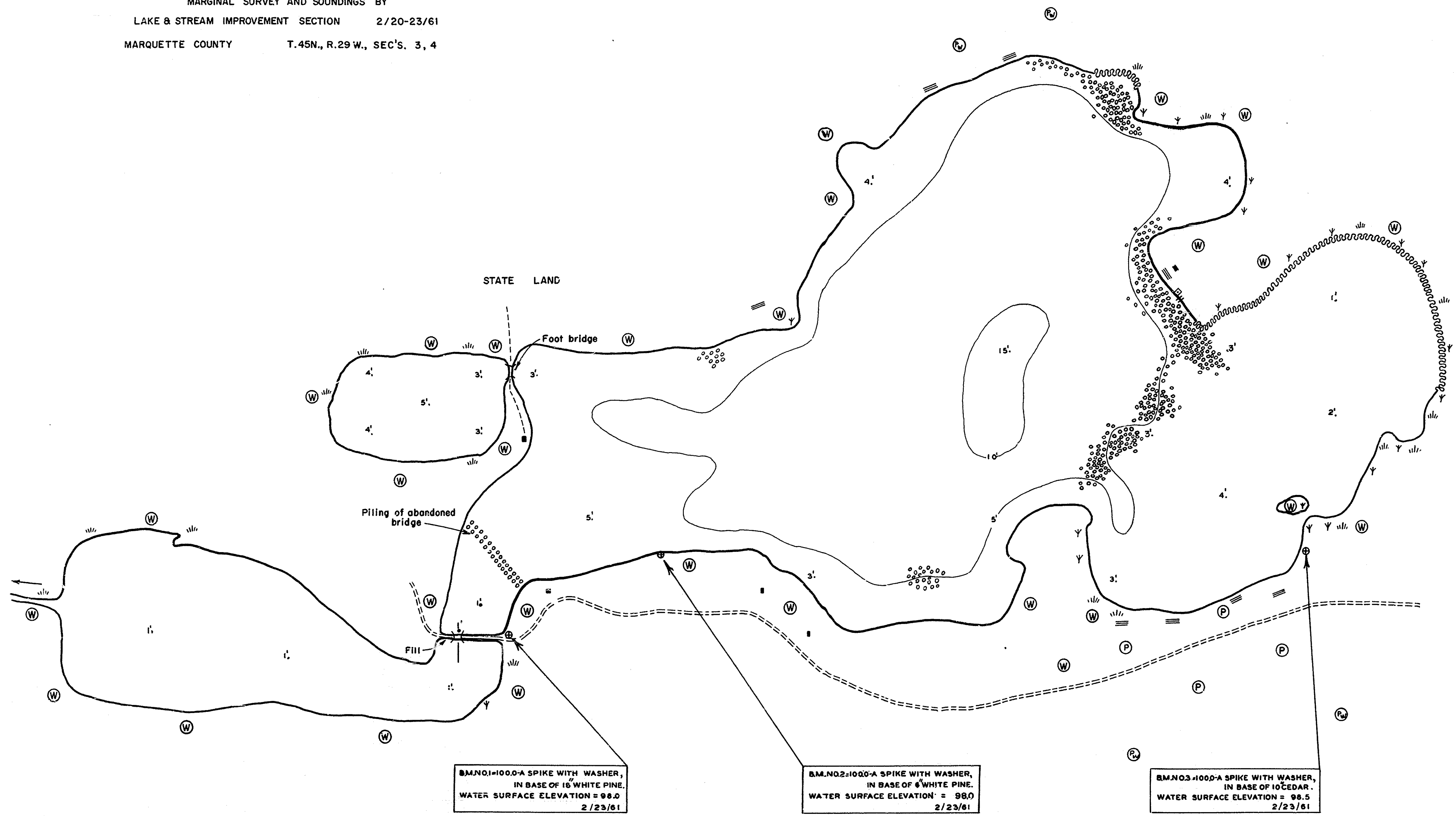

BM.N01=100.0-A SPIKE WITH WASHER,  
 IN BASE OF 16' WHITE PINE.  
 WATER SURFACE ELEVATION = 98.0  
 2/23/61

BM.N02=100.0-A SPIKE WITH WASHER,  
 IN BASE OF 6' WHITE PINE.  
 WATER SURFACE ELEVATION = 98.0  
 2/23/61

BM.N03=100.0-A SPIKE WITH WASHER,  
 IN BASE OF 10' CEDAR.  
 WATER SURFACE ELEVATION = 98.5  
 2/23/61

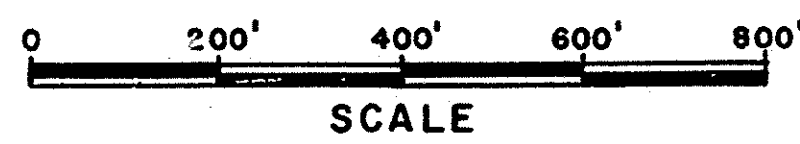

- LEGEND**
- BOTTOM**
- Organic
  - ⊙ Gravel
- OUTLINE & CONTOURS**
- ~ Shoreline
  - ⊘ Encroaching Shore
  - 5'- Contours
- SHORE FEATURES**
- ≡ Steep Slope
  - ⊙ Wooded
  - ⊙ Partly Wooded
  - ⊙ Cleared
  - Y Brush
  - ⊘ Marsh
  - Dock
  - Boathouse
  - Cottage
  - Unimproved Road
  - ≡ Bridge
  - Trail
  - ≡ Outlet