

INSTITUTE FOR FISHERIES RESEARCH
 DIVISION OF FISHERIES MICHIGAN CONSERVATION DEPT.
 LAKE INVENTORY MAP
AU SABLE LAKE
 AREA 271 ACRES
 MARGINAL SURVEY AND SOUNDINGS 2/19,20,22,23,24/43
 INVENTORY 8/19,20/49
 OGEMAW COUNTY T. 24 N., R. 4 E., SEC. 34, 35.

- LEGEND**
- BOTTOM**
- Sand
 - ▨ Marl
 - ▩ Marl and Sand
 - Pulpy peat
 - ▧ Pulpy peat and Marl
- OUTLINE & CONTOURS**
- Shoreline
 - - - Contours
- SHORE FEATURES**
- Cottage
 - Dock
 - || Slope
 - ⊥ Brush
 - == Improved road
 - - - Unimproved road
 - ⊙ Wooded
 - ⊙ Partly wooded
 - ⇨ Inlet
 - ⇩ Outlet

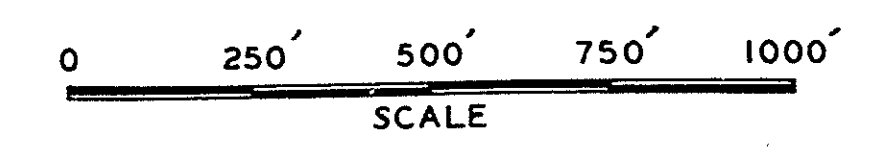
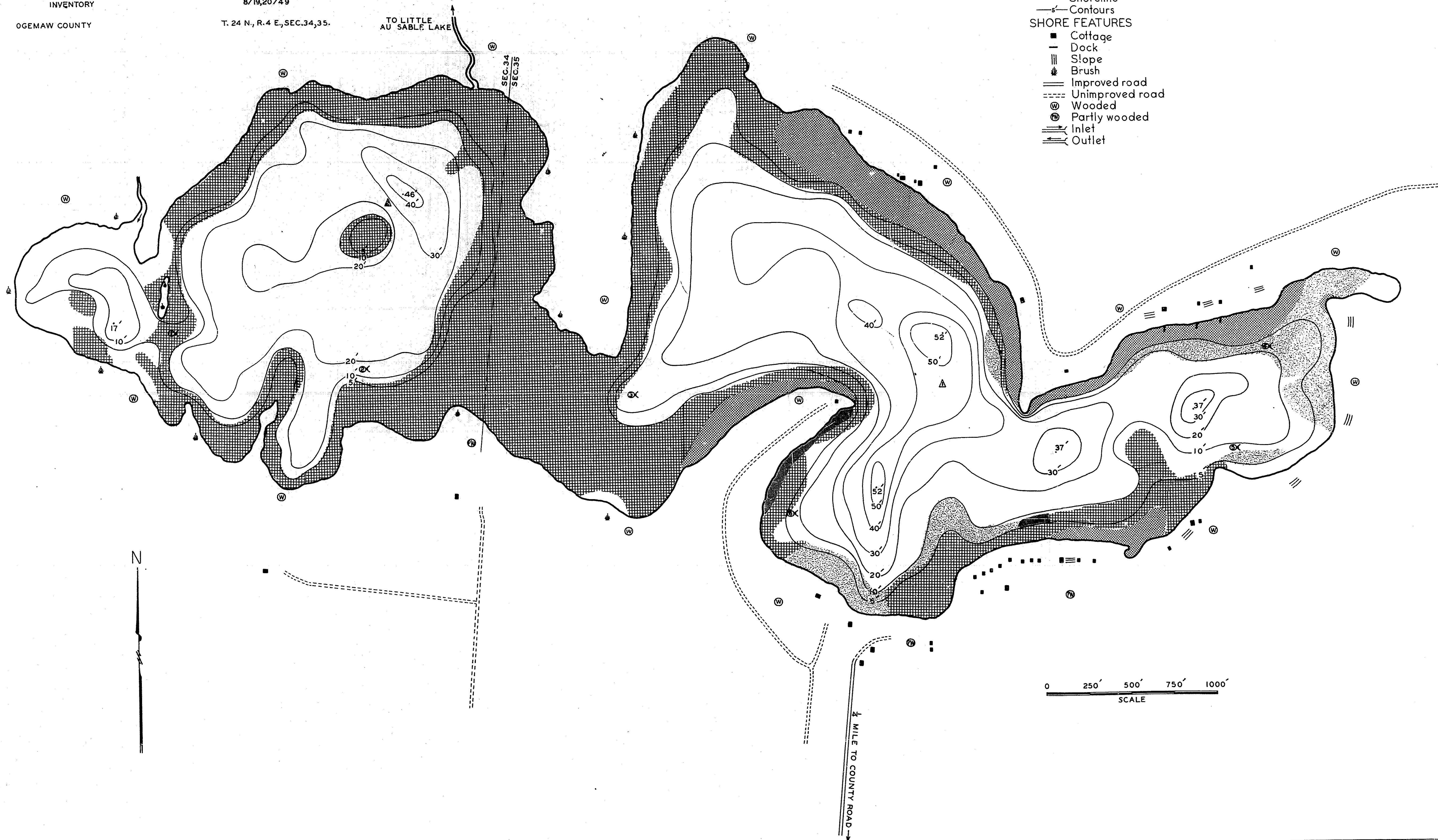

AU SABLE LAKE Ogemaw County T. 24 N., R. 4 E., Sec. 34, 35.