

Township N^o 49 N Range N^o 33 W Mer. Mich.

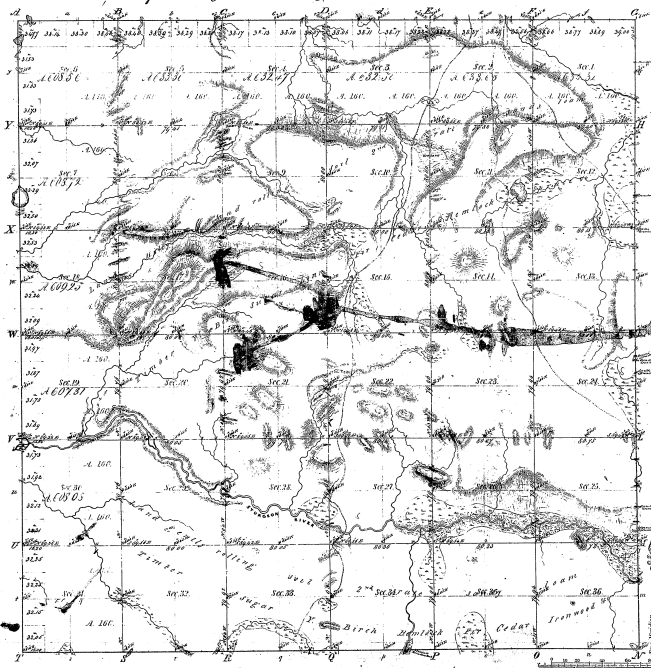

Measures of

| Feet | Centimes | 10 th Lines | 100 th Lines | 1000 th Lines |
|------|----------|------------------------|-------------------------|--------------------------|
| 44 | | | | |

Total number of Acres 22,718 1/2

| By Whom Surveyed | Date of Conject | Amount of Survey | When Surveyed | Plan of the land as the Section is laid |
|------------------|-----------------------------|------------------|----------------------------|---|
| Township lines | March 21st 1824 | 11 92 1/2 | 1 st March 1824 | |
| Subdivisions | March 21 st 1824 | 11 92 1/2 | 1 st March 1824 | |

This above copy of Township N^o 49 N of Range N^o 33 West of the Principal Meridian of Michigan is hereby conformable to the field notes of the survey thereof on file in this Office, which have been examined and approved.

Survey General Office
Detroit March 24 1825

Seander Chapman
Supt. Genl.