

Township N. 11. North, Range N. 11. East 4th. (M. T. Co.)

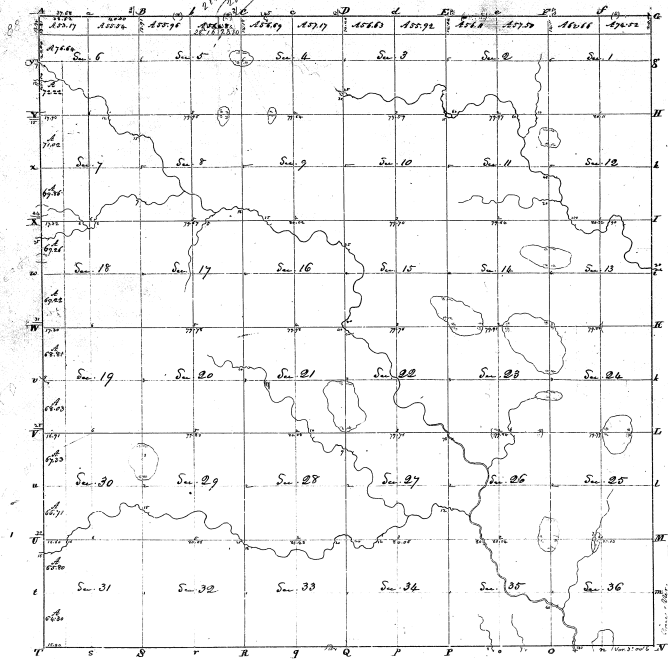

Surveyed in March 9th April 1881. by Harvey Parks S.S.

The above Map of Township N. 11. North of Range N. 11. East of the principal Meridian (M. T. Co.) is hereby confirmed to the first 24 notes of the above survey, on file in this Office, which have been assumed to be correct.
Surveyor General's Office.
Cincinnati, Aug. 3rd 1883.

M. T. Williams
Sur. Gen.

Section		Acreage		Deductions		Balance	
No.	Acres	No.	Acres	No.	Acres	No.	Acres
N. 11. 1	36.00	1	36.00	1	36.00	1	36.00
N. 11. 2	36.00	2	36.00	2	36.00	2	36.00
N. 11. 3	36.00	3	36.00	3	36.00	3	36.00
N. 11. 4	36.00	4	36.00	4	36.00	4	36.00
N. 11. 5	36.00	5	36.00	5	36.00	5	36.00
N. 11. 6	36.00	6	36.00	6	36.00	6	36.00
N. 11. 7	36.00	7	36.00	7	36.00	7	36.00
N. 11. 8	36.00	8	36.00	8	36.00	8	36.00
N. 11. 9	36.00	9	36.00	9	36.00	9	36.00
N. 11. 10	36.00	10	36.00	10	36.00	10	36.00
N. 11. 11	36.00	11	36.00	11	36.00	11	36.00
N. 11. 12	36.00	12	36.00	12	36.00	12	36.00
N. 11. 13	36.00	13	36.00	13	36.00	13	36.00
N. 11. 14	36.00	14	36.00	14	36.00	14	36.00
N. 11. 15	36.00	15	36.00	15	36.00	15	36.00
N. 11. 16	36.00	16	36.00	16	36.00	16	36.00
N. 11. 17	36.00	17	36.00	17	36.00	17	36.00
N. 11. 18	36.00	18	36.00	18	36.00	18	36.00
N. 11. 19	36.00	19	36.00	19	36.00	19	36.00
N. 11. 20	36.00	20	36.00	20	36.00	20	36.00
N. 11. 21	36.00	21	36.00	21	36.00	21	36.00
N. 11. 22	36.00	22	36.00	22	36.00	22	36.00
N. 11. 23	36.00	23	36.00	23	36.00	23	36.00
N. 11. 24	36.00	24	36.00	24	36.00	24	36.00
N. 11. 25	36.00	25	36.00	25	36.00	25	36.00
N. 11. 26	36.00	26	36.00	26	36.00	26	36.00
N. 11. 27	36.00	27	36.00	27	36.00	27	36.00
N. 11. 28	36.00	28	36.00	28	36.00	28	36.00
N. 11. 29	36.00	29	36.00	29	36.00	29	36.00
N. 11. 30	36.00	30	36.00	30	36.00	30	36.00
N. 11. 31	36.00	31	36.00	31	36.00	31	36.00
N. 11. 32	36.00	32	36.00	32	36.00	32	36.00
N. 11. 33	36.00	33	36.00	33	36.00	33	36.00
N. 11. 34	36.00	34	36.00	34	36.00	34	36.00
N. 11. 35	36.00	35	36.00	35	36.00	35	36.00
N. 11. 36	36.00	36	36.00	36	36.00	36	36.00
Total	216.00	Total	216.00	Total	216.00	Total	216.00

17
18
19
20