

Township N. 13 South, Range N. 17 West Mer. 10c. 10c.

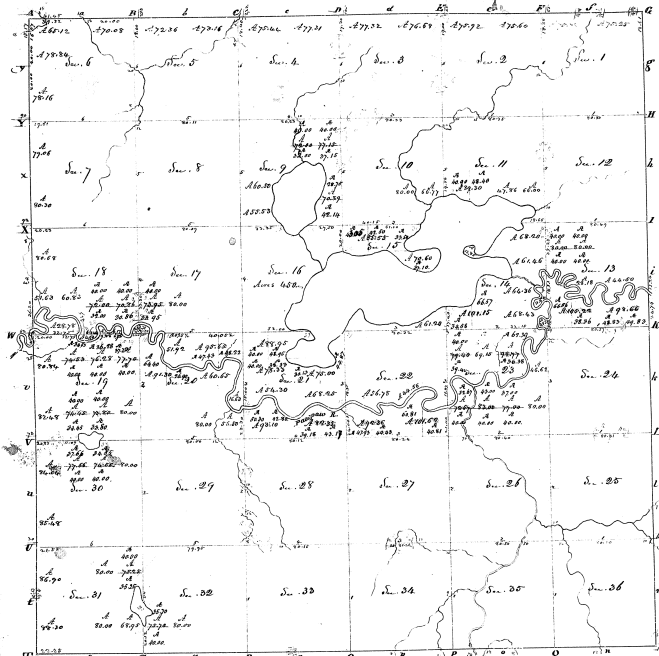

Surveyed February March 1830, by *John H. ...*

Scale 400 ft to an inch

1/4 Sec. 1	200
1/4 Sec. 2	200
1/4 Sec. 3	200
1/4 Sec. 4	200
1/4 Sec. 5	200
1/4 Sec. 6	200
1/4 Sec. 7	200
1/4 Sec. 8	200
1/4 Sec. 9	200
1/4 Sec. 10	200
1/4 Sec. 11	200
1/4 Sec. 12	200
1/4 Sec. 13	200
1/4 Sec. 14	200
1/4 Sec. 15	200
1/4 Sec. 16	200
1/4 Sec. 17	200
1/4 Sec. 18	200
1/4 Sec. 19	200
1/4 Sec. 20	200
1/4 Sec. 21	200
1/4 Sec. 22	200
1/4 Sec. 23	200
1/4 Sec. 24	200
1/4 Sec. 25	200
1/4 Sec. 26	200
1/4 Sec. 27	200
1/4 Sec. 28	200
1/4 Sec. 29	200
1/4 Sec. 30	200
1/4 Sec. 31	200
1/4 Sec. 32	200
1/4 Sec. 33	200
1/4 Sec. 34	200
1/4 Sec. 35	200
1/4 Sec. 36	200

Cont. 10c	Cont. 5
Sec. 1	75.25
Sec. 2	75.25
Sec. 3	75.25
Sec. 4	75.25
Sec. 5	75.25
Sec. 6	75.25
Sec. 7	75.25
Sec. 8	75.25
Sec. 9	75.25
Sec. 10	75.25
Sec. 11	75.25
Sec. 12	75.25
Sec. 13	75.25
Sec. 14	75.25
Sec. 15	75.25
Sec. 16	75.25
Sec. 17	75.25
Sec. 18	75.25
Sec. 19	75.25
Sec. 20	75.25
Sec. 21	75.25
Sec. 22	75.25
Sec. 23	75.25
Sec. 24	75.25
Sec. 25	75.25
Sec. 26	75.25
Sec. 27	75.25
Sec. 28	75.25
Sec. 29	75.25
Sec. 30	75.25
Sec. 31	75.25
Sec. 32	75.25
Sec. 33	75.25
Sec. 34	75.25
Sec. 35	75.25
Sec. 36	75.25

6-1

2,321.50
2,325.10
2,328.70