

Township N. IV South, Range N. XIX West Mer. (Misc. Sec.)

1-16

1-16 - 2

LAKE MICHIGAN.

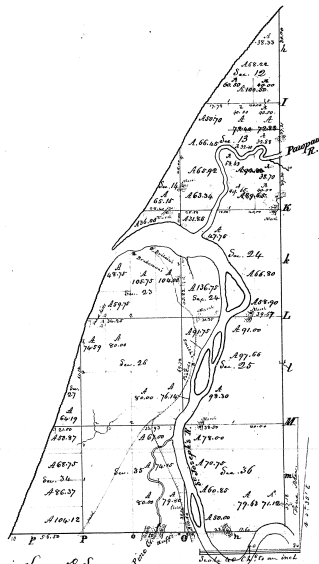

Contents	
Acres	Sq. Ft.
Sec. 12	36.33
Sec. 17	67.25
Sec. 18	100.00
Sec. 19	79.88
Sec. 20	74.00
Sec. 21	50.70
Sec. 22	66.00
Sec. 23	70.23
Sec. 24	89.60
Sec. 25	65.92
Sec. 26	63.24
Sec. 27	65.00
Sec. 28	26.00
Sec. 29	102.00
Sec. 30	100.75
Sec. 31	63.75
Sec. 32	37.75
Sec. 33	160
Sec. 34	47.75
Sec. 35	21.75
Sec. 36	124.75
Sec. 37	66.50
Sec. 38	58.50
Sec. 39	81.00
Sec. 40	17.88
Sec. 41	16.00
Sec. 42	28.50
Sec. 43	17.70
Sec. 44	160
Sec. 45	50
Sec. 46	74.57
Sec. 47	14.74
Sec. 48	50
Sec. 49	160
Sec. 50	64.19
Sec. 51	37.75
Sec. 52	67.75
Sec. 53	54.75
Sec. 54	104.15
Sec. 55	67.00
Sec. 56	74.15
Sec. 57	77.50
Sec. 58	50
Sec. 59	32.0
Sec. 60	160
Sec. 61	75.00
Sec. 62	70.75
Sec. 63	71.75
Sec. 64	77.50
Sec. 65	60.75
Sec. 66	50
Sec. 67	18.50
Total	4447.77

Surveyed in August 1819 - by Dennis Lyon C.S.
 & March 1830 - by John Nuttall C.S.

Township N^o 4 S. Range N^o 19 W.

Mer. Mich

Islands in St. Josephs River.

E. 1/4 S. 23. N. 89° 10' 30" W. 11.06-11.81

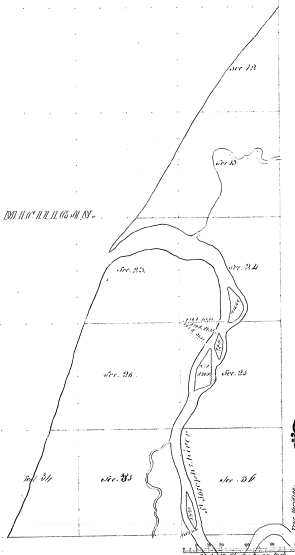

1-16

Shoal		Bar		Point		Course		Wind	
No.	Description	No.	Description	No.	Description	No.	Description	No.	Description

1-16

Total number of Acres 421

Survey suggested	By Whom suggested	Date of survey	Amount of Survey		When changed to the last survey
			M. 26	Ac.	
Township line	Wm. Howard	11-16-1843	4	70	1843
Division of Subdivisions					

The above copy of Township N^o 4 S. Range N^o 19 W. is a study copy in the field office of the survey shown on file in this office which have been examined and approved.

Surveyor General's Office
Chas. W. Smith

Darius Lyon, Asst. Genl.