

Township N^o 35 N Range N^o 9 W

Mer.

L A K E M I C H I G A N

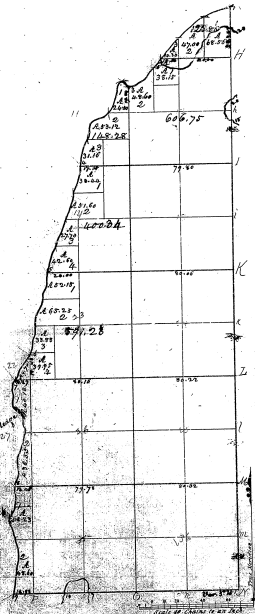

Section	Area	Acres	Value	Owner
1	100.00	100.00		
2	100.00	100.00		
3	100.00	100.00		
4	100.00	100.00		
5	100.00	100.00		
6	100.00	100.00		
7	100.00	100.00		
8	100.00	100.00		
9	100.00	100.00		
10	100.00	100.00		
11	100.00	100.00		
12	100.00	100.00		
13	100.00	100.00		
14	100.00	100.00		
15	100.00	100.00		
16	100.00	100.00		
17	100.00	100.00		
18	100.00	100.00		
19	100.00	100.00		
20	100.00	100.00		
21	100.00	100.00		
22	100.00	100.00		
23	100.00	100.00		
24	100.00	100.00		
25	100.00	100.00		
26	100.00	100.00		
27	100.00	100.00		
28	100.00	100.00		
29	100.00	100.00		
30	100.00	100.00		
31	100.00	100.00		
32	100.00	100.00		
33	100.00	100.00		
34	100.00	100.00		
35	100.00	100.00		
36	100.00	100.00		

Total number of Acres 5899.75

Owner	By Whom Surveyed	Date of Survey	Amount of Acres	Value	Remarks
S. Boundary of Section 11	Wm. H. H. H.	1851	2 1/2	98.8	
Section 21	Wm. H. H.	1851	63.70	2.11	

This plat of the Township of 35 N. of Range 9 W. of the 1st Meridian is hereby confirmed to the following owners of the same in accordance with the laws of the State of Michigan.

Witness my hand and the seal of the State of Michigan this 26th day of June 1851.

Gov. P. G. B. S. J. R.

Original.

9440

18-12

②
18-12

Tp. 33 N. R. 9 W Michigan.

• all lengths of the Survey
line is taken to ft. water mark.

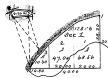

Department of the Interior
General Land Office
October 24th 1888.

I hereby certify that the above is a diagram made
in accordance with Section 2219 U. S. Statutes of
Fractional Section 1, in Township 33 North Range
9 West of the Principal Meridian Michigan and
showing Fishermans Island as surveyed by U. S.
Deputy Surveyor Joseph W. Dixon.

J. H. Wesley
Commissioner
and Ex-officio Surveyor General
of Michigan.