

Resurvey

Township 1° 37' N. Range 1° 3' W.

Mer. Mich.

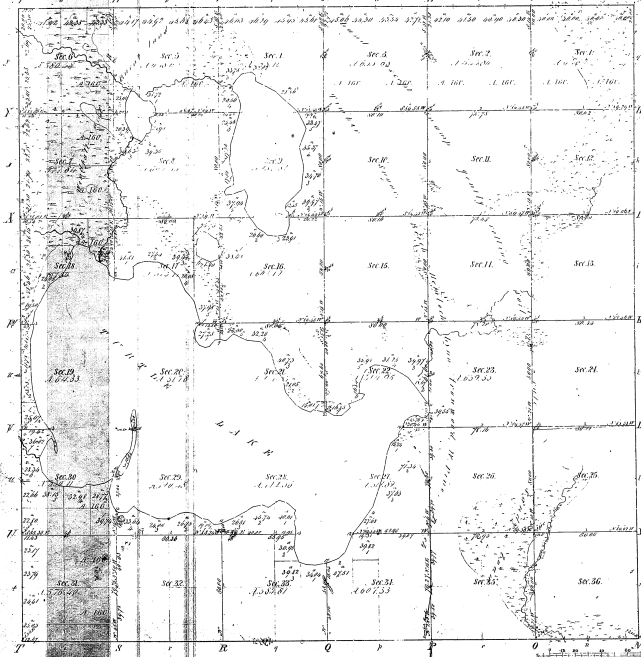

Boundaries of  
Twp. 1° 37' N. R. 1° 3' W. Mer. Mich.

19-16

Note: Shaded areas represent lands sold at the commencement of the survey. The position of each old line and corner as now found is noted on this map.

W. J. S. 25th Dec 1877

Total number of Acres 15722.2

Survey	When Surveyed	Date of Contract	Amount of Survey	When Surveyed	How far from the Survey
Township	1877	April 27 1858	71 53 39	2nd June 1868	
Subdiv.	1877	April 27 1858	88 53 00	2nd June 1868	

The above map of Township 1° 37' N. Range 1° 3' W. Mer. Mich. is a true and correct copy of the original map of the Township as shown to the field notes of the surveying party in the office and has been examined and approved.

Surveyor General's Office,  
St. Louis, Missouri, 25 1868

*Seander Blodgett* Surveyor

Don't Copy made