

Township N<sup>o</sup> 45 N. Range N<sup>o</sup> 1 W. Mer. Mich.

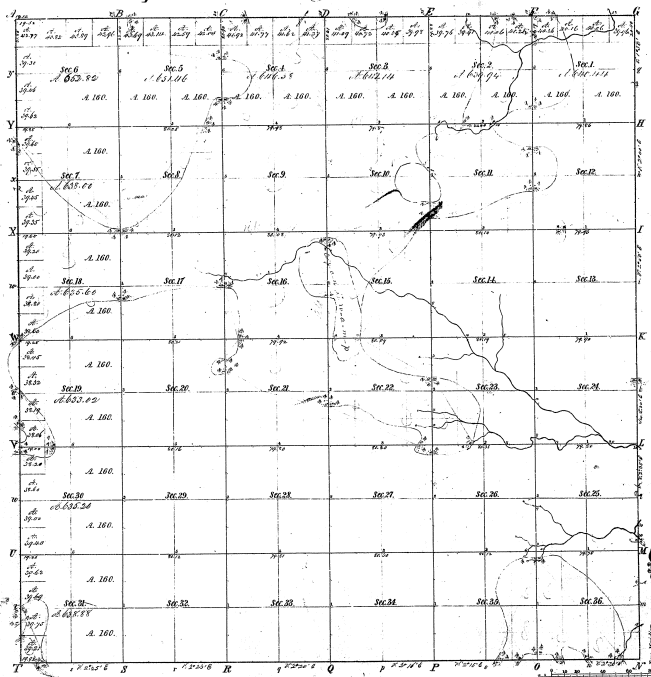

Bearings of		Distances		Bearings of		Distances	
Point	Course	Bearing	Distance	Point	Course	Bearing	Distance
34.27							
34-27							

Total number of Acres 23034.05

Survey designated	By whom Surveyed	Date of Contract	Amount of Survey	When Surveyed	Amount for and by the Sur. Com <sup>rs</sup> paid
Township Lines	Wm. G. Smith	May 15 1856	M. G. S. 142	5 of 25 1856	
Subdivisions	John S. Decker	Apr 29 1856	66. 61 52	27 of 25 1856	

The above Map of Township N<sup>o</sup> 45 North of Range N<sup>o</sup> 1 West of the Principal Meridian is hereby certified as a correct and faithful copy of the original notes of the survey thereof from the original files which have been examined and approved.

Surveyor General's Office  
 Detroit, Dec 11 1856  
 Lucius Lyon, Sur. Gen.