

Resurvey
 Township 17° 17' N Range 4 W Mer. Mich.

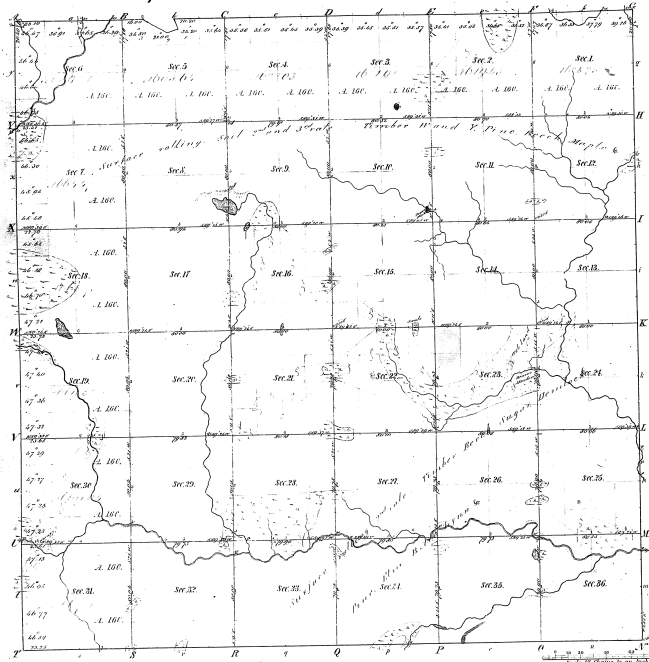

Survey Designated	By Whom Surveyed	Date or Contd.	Amount of Survey	When Surveyed
Township	John D. Anderson	Jan. 22 1857	76 58 63	1857
Subdivisions	H. C. L. Bush		60 07 38	1857

Total number of acres

The above copy of survey of 15 1/4 blocks of Range 13 is that of the original sections of the township as shown on the plat of the survey filed on file in this office, which have been examined and approved.
George S. Condit
 Deput. Secy. of the Office
 Detroit Sept. 11 1851

Boundaries of		1851		1852		1853	
Prof.	Course	Dist.	Course	Dist.	Course	Dist.	Course
13		13					

13-13