

Re Survey
 Township 1° 26' N Range 1° 3' W Mer. Mich.

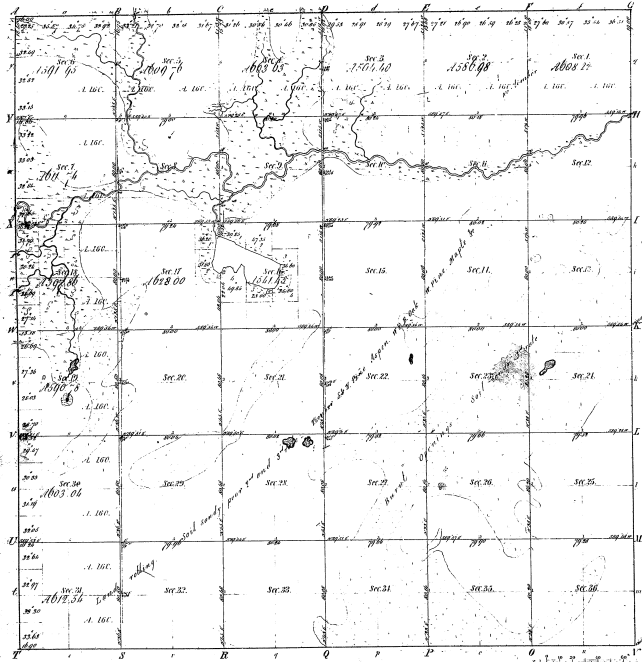

Meridian of
 Public Center 1812' Public Center 1812' Public Center 1812'

14-18
 14-18

2.07.19

Total number of Acres 22548.35

Survey designated	By whom surveyed	Date of Central	Amount of Survey	When surveyed	When surveyed
County lines	Walter Brown	May 19 1854	11 74.86	1854	1854
Subdivisions	William Brown	April 25 1854	6 11 76	1854	1854

The above map of Township 1° 26' N of Range 1° 3' West of Meridian Michigan is hereby certified to be a true and correct copy of the original survey on file in this office, which has been examined and approved.
 Surveyor General's Office Charles A. Smith
 Detroit March 19 1858