

Township 1° 35' N Range 1° 24' W Mer.

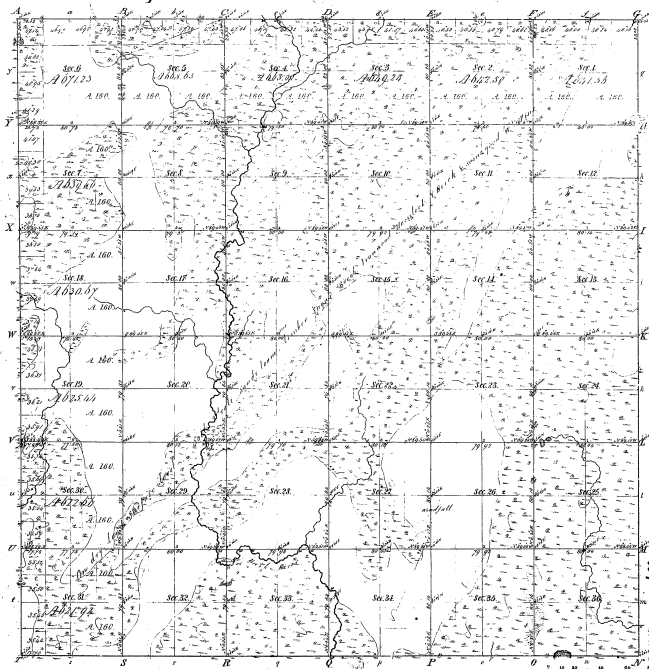

46-33

Number of	Acres	Acres	Acres	Acres	Acres
1					
2					
3					
4					
5					
6					
7					
8					
9					
10					
11					
12					
13					
14					
15					
16					
17					
18					
19					
20					
21					
22					
23					
24					
25					
26					
27					
28					
29					
30					
31					
32					
33					
34					
35					
36					

Total number of acres, 23076.34

Survey designated	By Whom Surveyed	Date of Contract	Amount of Survey	When Surveyed	How far and what to the Section
123	John A. Stewart	March 18, 1857	36	1857	1/4 Sec. 20
124	Geo. F. Adams	March 21, 1857	36	1857	1/4 Sec. 20
222	Thomas River	March 25, 1857	36	1857	1/4 Sec. 20

The above Map of Township 1° 35' North of Range 1° 24' West of the Principal Meridian Michigan is a true and correct copy of the original survey map on file in this office, which has been examined and approved.

Surveyor General's Office,
 Detroit, July 16, 1863

Scaudon Chapman
 Surveyor

46-33