

46-21 (3)

TOWNSHIP 39 NORTH, RANGE 20 WEST OF THE MICHIGAN MERIDIAN, MICHIGAN
 SURVEY OF ST. VITAL ISLAND, SECTION 3

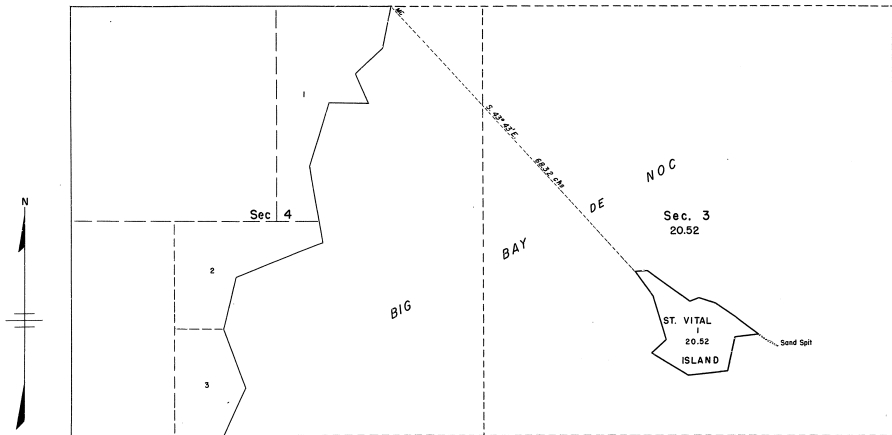

This plat represents the survey of St. Vital Island in Big Bay de Noc of Lake Michigan, which was not included in the original survey of the township which is represented on the plat approved August 21, 1849.

Surveyed by Norville E. Shearer, Cartographer (Cadastral), on Sept. 7, 1955, under Special Instructions dated April 29, 1955 and Supplemental Special Instructions dated August 5, 1955 for Group 63, Michigan.

UNITED STATES DEPARTMENT OF THE INTERIOR
 BUREAU OF LAND MANAGEMENT
 Washington, D. C. February 17, 1956

This plat is strictly conformable to the approved field notes, and the survey, having been correctly executed in accordance with the requirements of law and the regulations of this Bureau, is hereby accepted.

For the Director
Earl A. Washington
 Cadastral Engineering UNIT OFFICER