

Township N^o 48N. Range N^o 44W.

Mer. Mich.

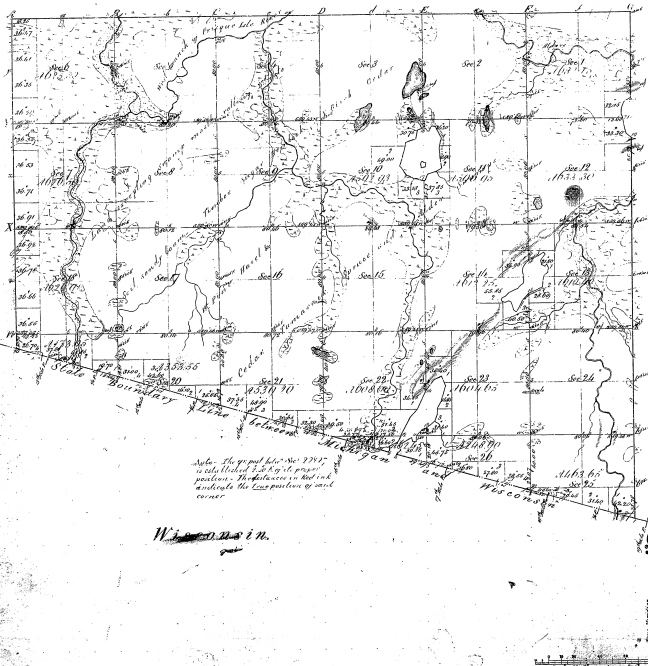

Wisconsin

42-37

Subdivisions of		Township		Range		County	
Section	Acres	Section	Acres	Section	Acres	Section	Acres
12-37							
is considered to be the full acre.							

Total number of acres 75,011.05

Survey	No. Acres Surveyed	Date of Survey	Amount of Survey	No. Acres Surveyed	When Closed or by what authority
Original	6,62.79	April 1857	6,62.79	6,62.79	Original
Subsequent	68,388.26	April 1857	68,388.26	68,388.26	Original
Subsequent	16,79.05	April 1857	16,79.05	16,79.05	Original

The above list of Township N48 South of Range N44 West of the Principal Meridian Michigan is a listing conformable to the full acre of the survey listed on file in this Office, which have been examined and approved.

Surveyor General's Office
Detroit May 11th 1858

Wm. H. H. [Signature]

PLAT OF AN ISLAND
in
Mink Lake,
Secs. 10 and 11, T.45 N., R. 44 W., Mich. Mer.,
MICHIGAN.

42.37
42.37 - 2

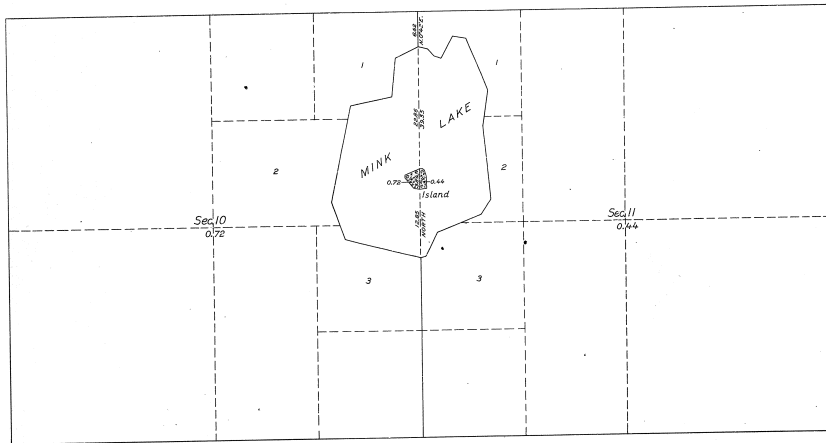

The undersigned hereby certifies that the survey delineated upon this plat has been executed under his general direction and in accordance with the approved special instructions issued pursuant to authority contained in office letter 225740 "M" JM, dated April 1, 1921, addressed to the Secretary of the Interior (Approved April 6, 1921), and that the plat and the field notes of the survey have been carefully verified.

Washington, D. C.,
March 2, 1925.

A. W. Liden
Associate Supervisor of Surveys.

LEGEND.

Scale: 1 inch = 10 chains.

Surveyed by Guy R. Veal, U. S. Cadastral Engineer, on September 9, 1921, under special instructions for Group No. 1, Michigan, dated August 1, 1921, issued by Arthur S. Kidder, Associate Supervisor of Surveys, which were approved by the Commissioner of the General Land Office on August 9, 1921.

Area of lands surveyed = 1.16 Acres.
Areas of previously surveyed lands not shown.

Department of the Interior,
General Land Office,
Washington, D. C., March 5, 1925.

The above plat of an Island in Mink Lake, in Sections 10 and 11, Township 45 North, Range 44 West, of the Michigan Meridian, in the State of Michigan, is strictly conformable to the field notes of the survey thereof, on file in this office, which have been examined and approved.

William Gray
Commissioner and ex officio
U. S. Surveyor General for Michigan.