

Township 12<sup>th</sup> 48<sup>th</sup> N. Range 12<sup>th</sup> 46<sup>th</sup> W. Mer. Mich.

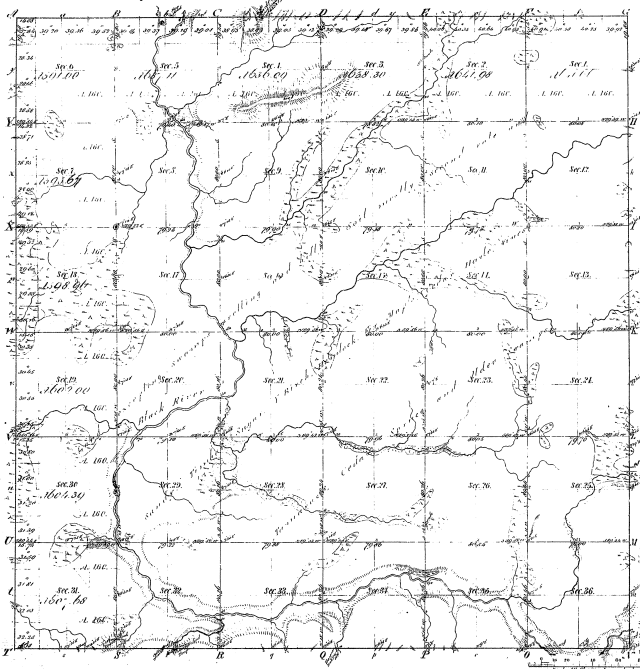

Total number of Acres 2794.84

Survey Designated	By Whom Surveyed	Date of Contract	Amount of Survey	When Surveyed	Whether or not in the Section 10 act
Boundary Lines	John Beard	Sept 27 1857	76 24 34	3 <sup>rd</sup> Quarter 1857	
Subdivisions	Richard Beard	April 16 1858	19 12 11	3 <sup>rd</sup> Quarter 1858	

The above copy of Township 12<sup>th</sup> 48<sup>th</sup> N. 46<sup>th</sup> W. Range 12<sup>th</sup> 46<sup>th</sup> W. Mer. Mich. is a true and correct copy of the original map on file in this office, which has been examined and approved.

Surveyor General's Office,  
St. Louis, Nov 6 1861

Charles S. Holt,  
Supt.

Number of  
Page Count 1242 Page Count 1242

4-18

4-18