

Township N. 10 North, Range N. III West 4th Mer. (Ill. Ter.)

502

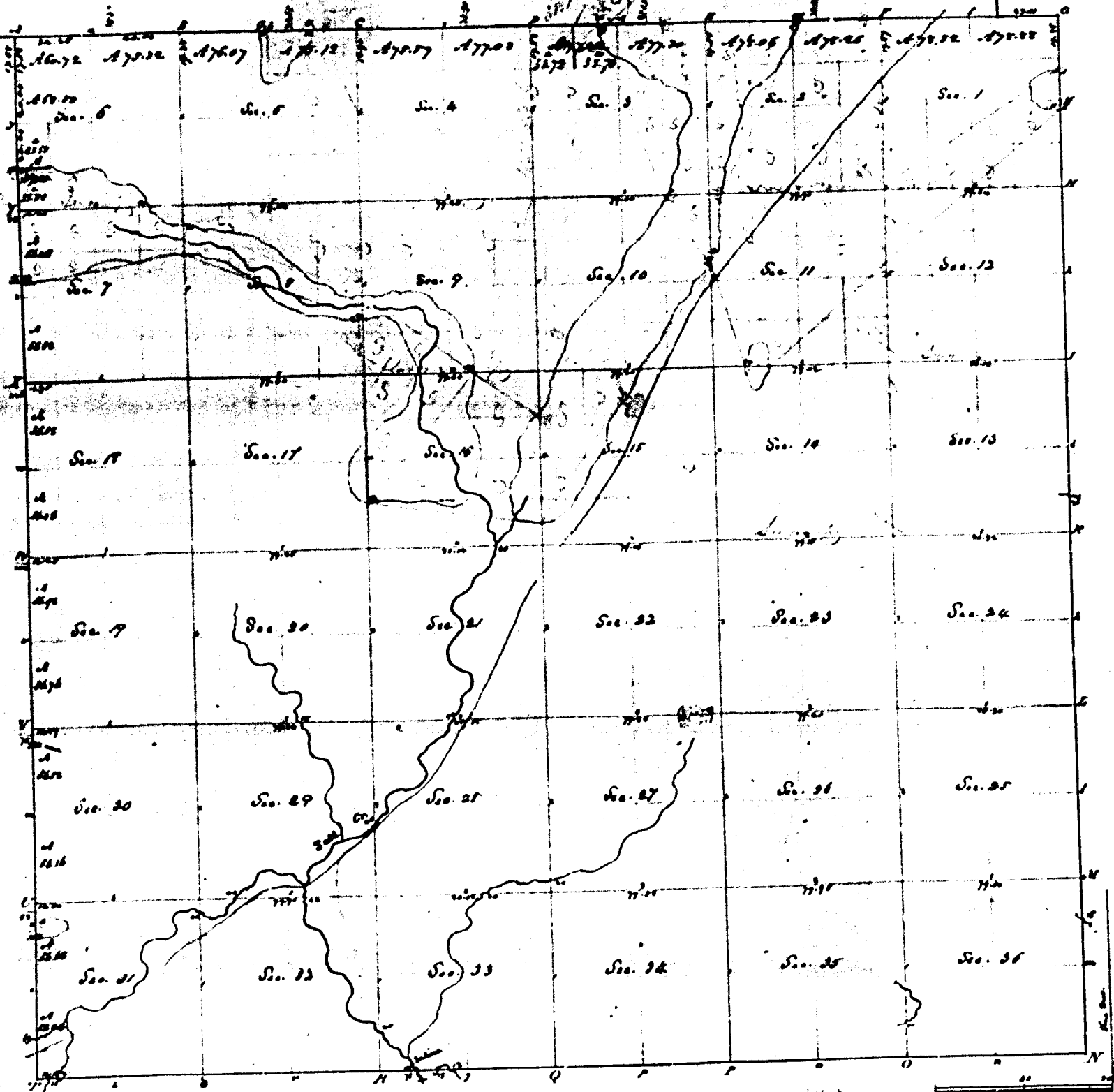

Sections	Class	Vol.	Sections	Area	Acres
1	67	75 11	67	11	320
2	80	80	67	11	50
3	77	77 52	77	11	58 92
4	80	80	67	67	80
5	320	320	77	11	58 76
6	77	77 21	Sec	20	640
7	80	80	21	21	640
8	77	77 05	22	22	640
9	80	80	23	23	640
10	320	320	24	24	640
11	77	77 30	25	25	640
12	80	80	26	26	640
13	77	77 42	27	27	640
14	80	80	28	28	640
15	320	320	29	29	640
16	77	77 03	30	30	320
17	80	80	67	11	80
18	77	77 59	77	11	56 52
19	80	80	67	67	80
20	320	320	77	11	58 15
21	77	77 12	67	11	320
22	80	80	67	11	80
23	77	77 07	77	11	58 68
24	80	80	67	67	80
25	320	320	77	11	58 04
26	77	77 32	Sec	20	640
27	80	80	21	21	640
28	77	60 72	22	22	640
29	80	65 80	23	23	640
30	56	160	24	24	640
31	57	80	11 381	08	
32	77	57 00	11 397	79	
33	67	320	12 715	87	
34	77	80			
35	77	58 48			
36	57	80			
	77	57 52			
	67	80			
	77	58 68			
	77	11 357	79		

Surveyed in . . . . . 1831 - by Lord Wright & S.

The above map of Township N. 10 N., Range N. 3 W. of the Mer. (Ill. Ter.) is strictly conformable to the field notes of the Survey kept on file in this office, which have been examined & approved  
 Surveyor General's Office  
 Cincinnati, Oct. 6, 1851  
 M. T. Williams  
 Secy.